

SERIES 4500 - UNA-CLAD PANEL INDEX

S4500-00

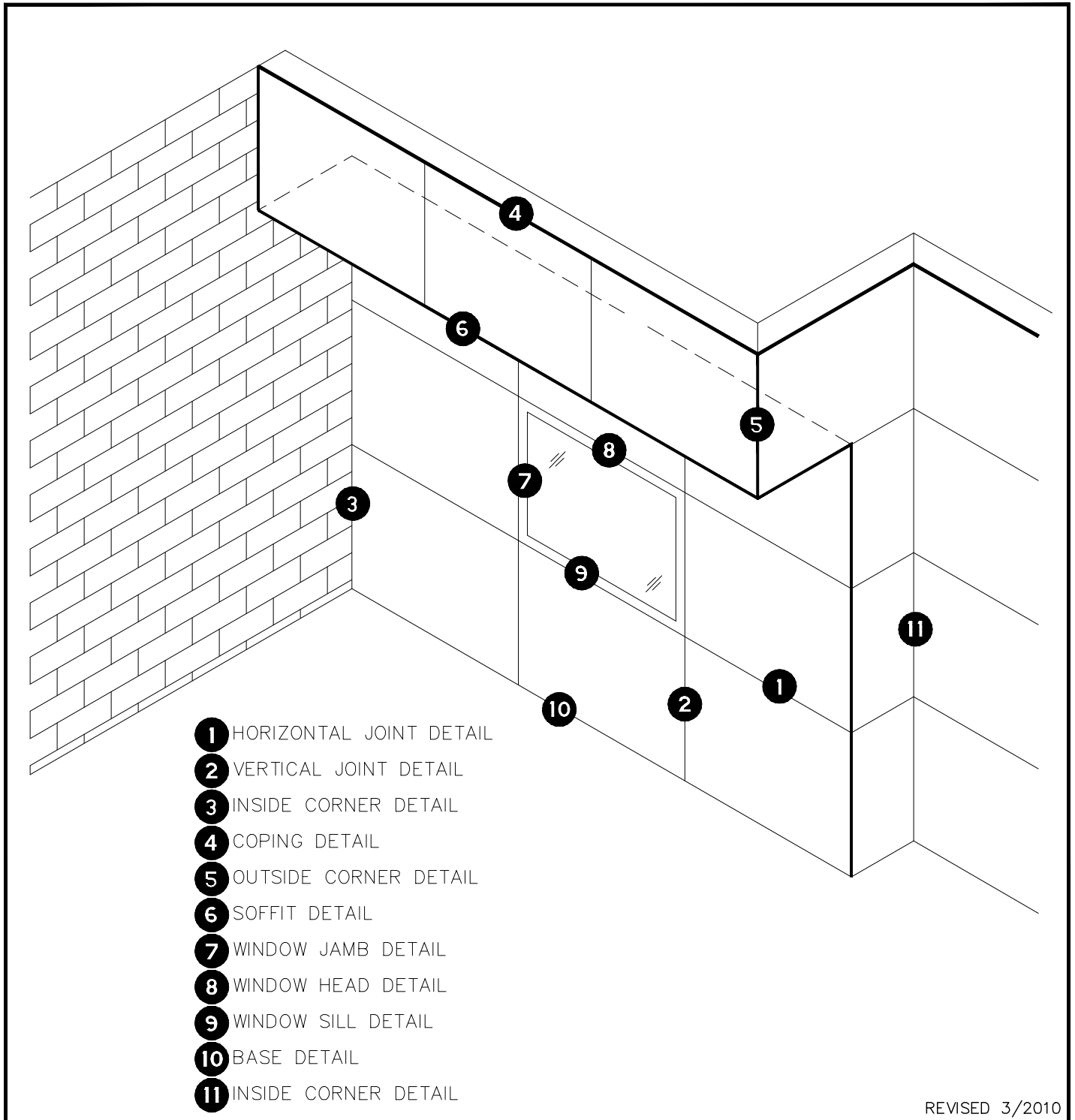

SERIES 4500 - HORIZONTAL JOINT DETAIL S4500-01

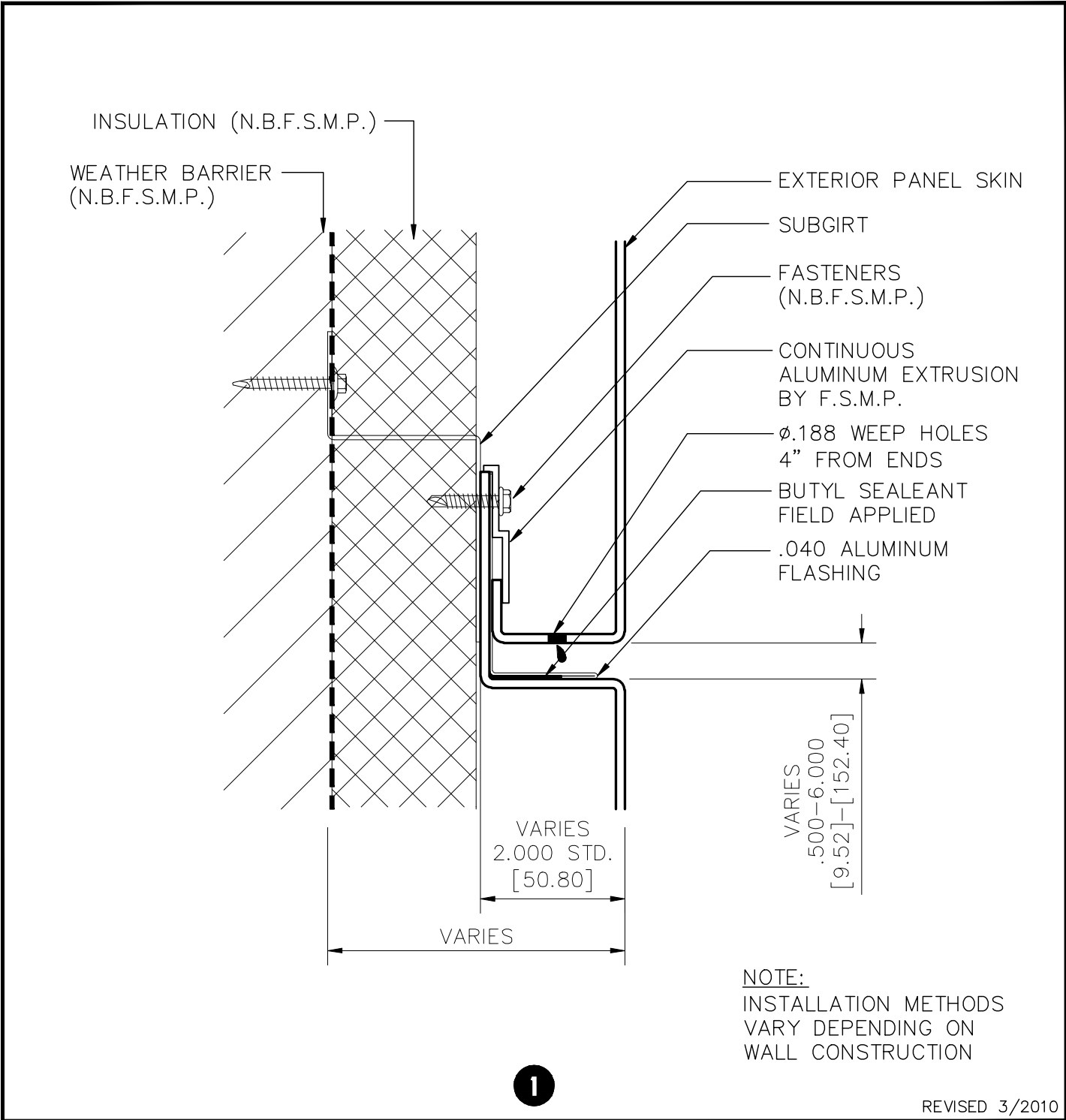

SERIES 4500 - VERTICAL JOINT DETAIL

S4500-02

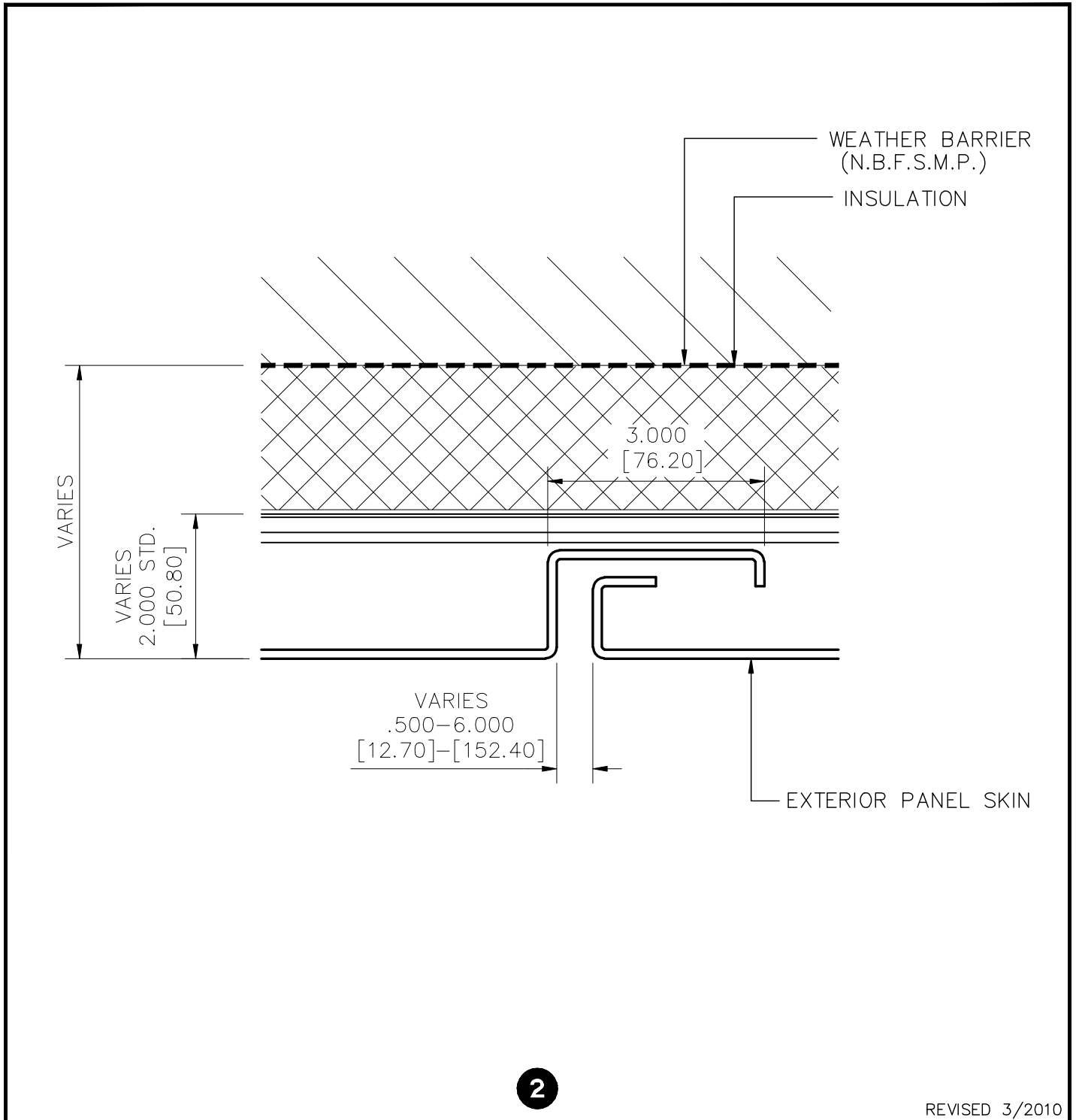

SERIES 4500 - INSIDE CORNER DETAIL

S4500-03

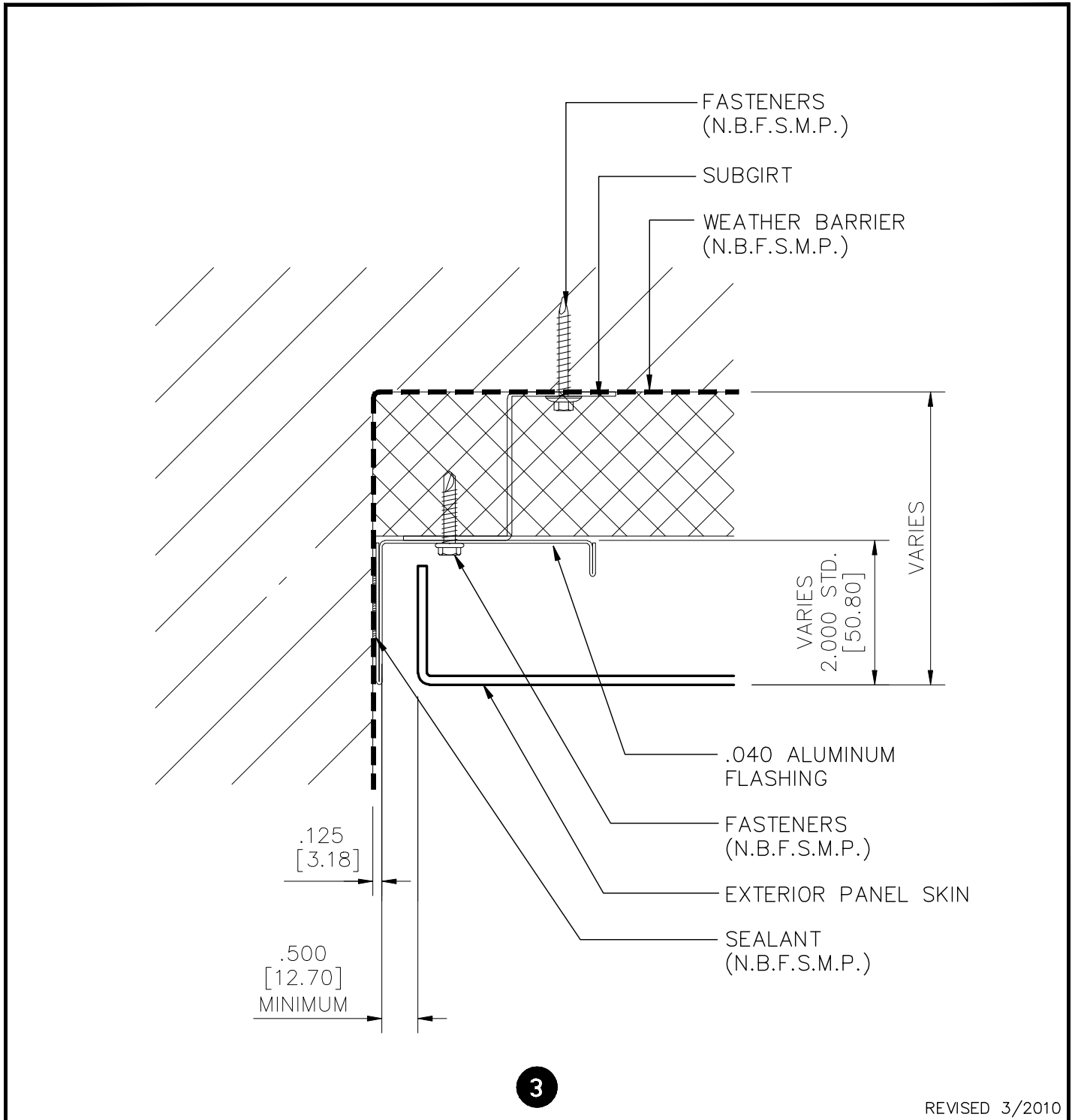

SERIES 4500 - COPING DETAIL

S4500-04A

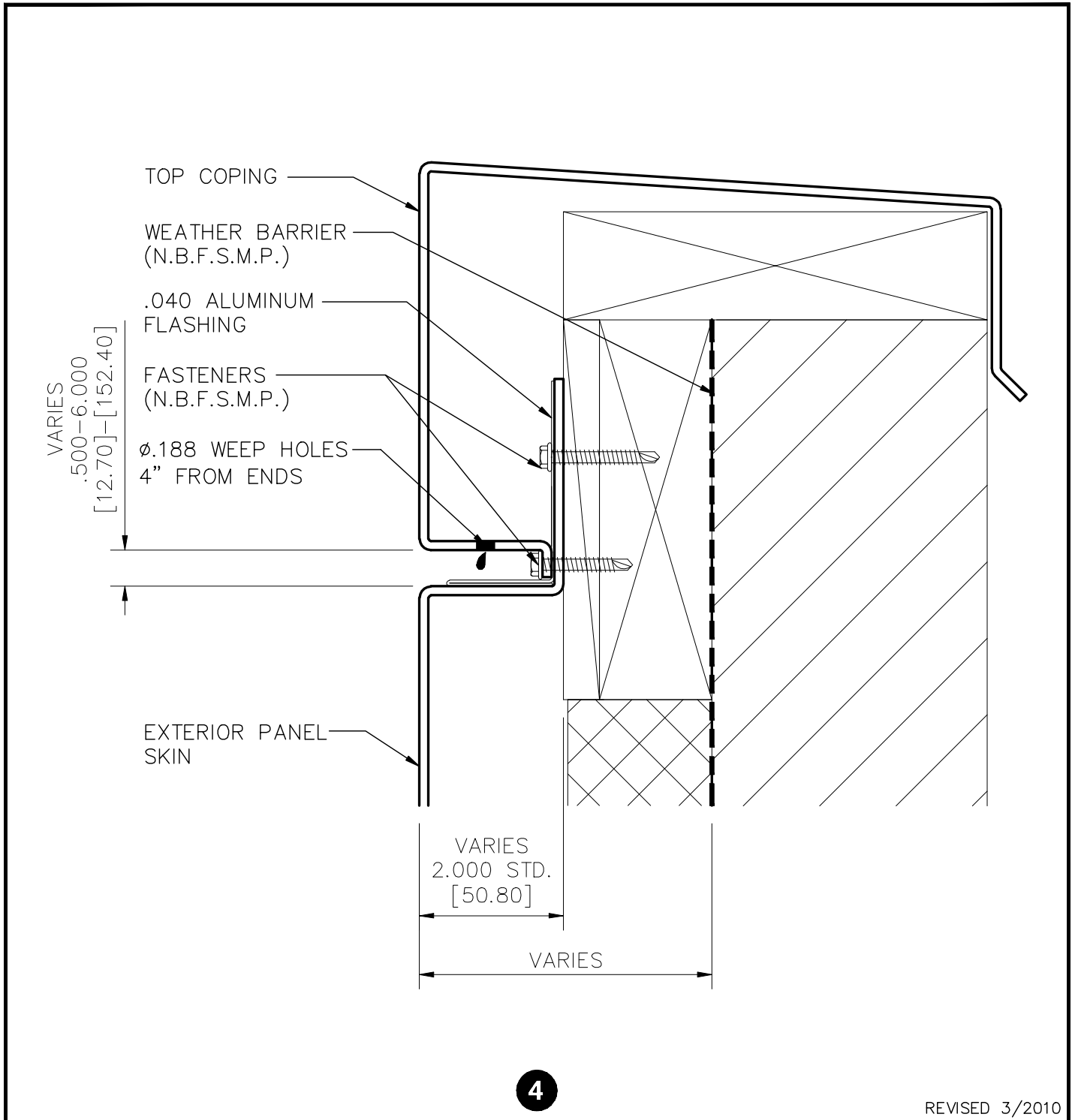

SERIES 4500 - COPING DETAIL

S4500-04

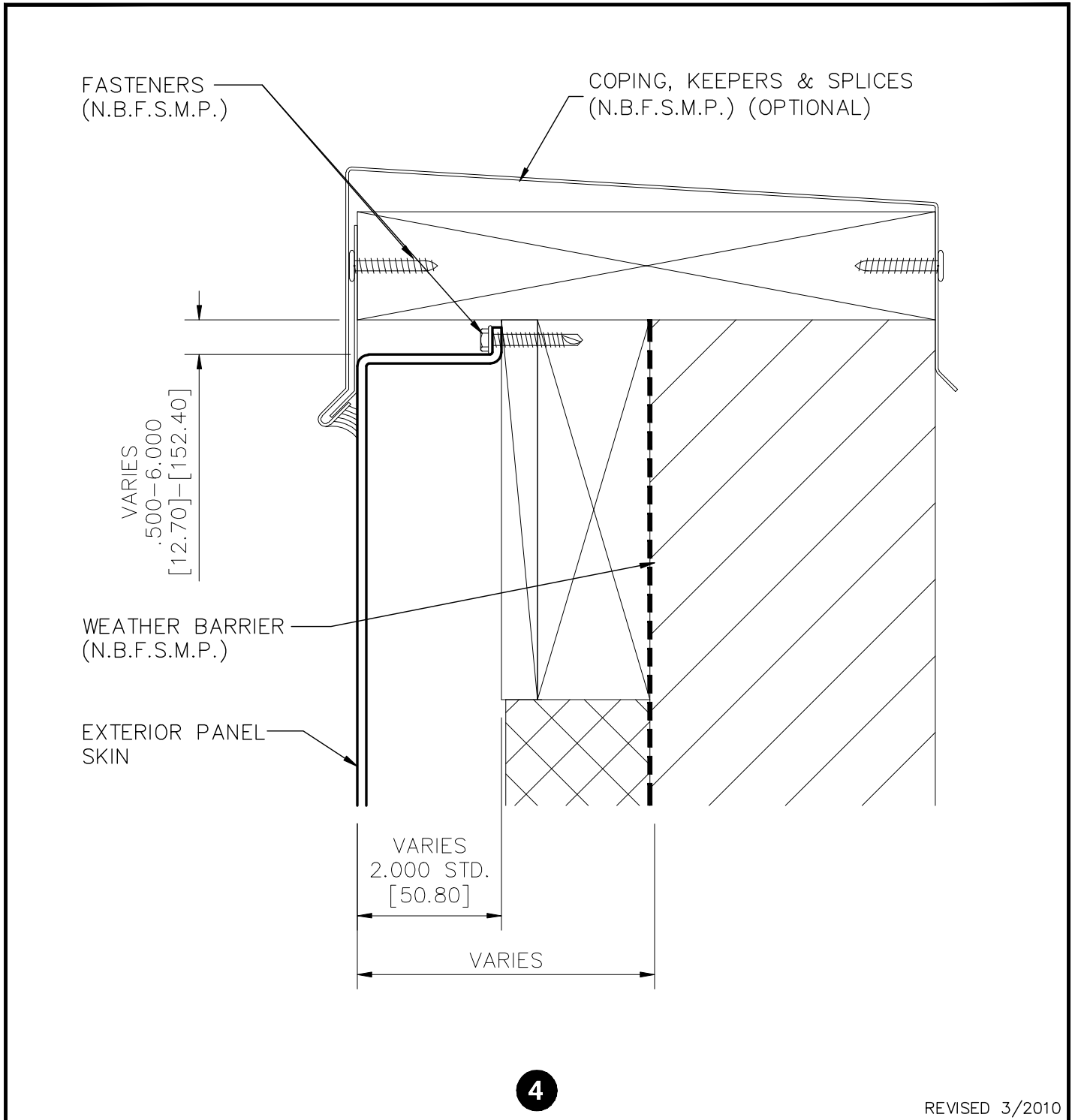

SERIES 4500 - OUTSIDE CORNER DETAIL

S4500-05A

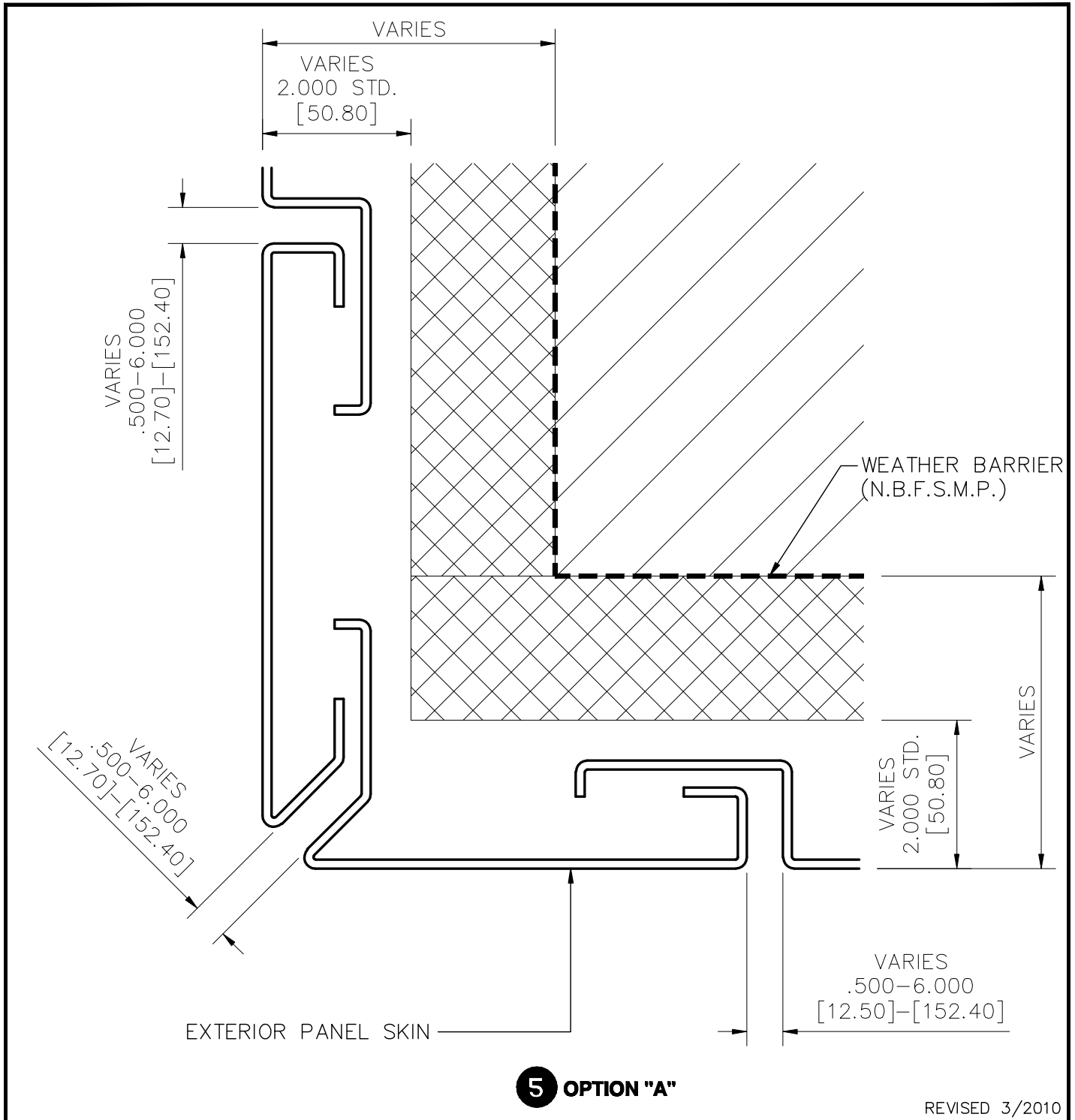

SERIES 4500 - OUTSIDE CORNER DETAIL

S4500-05

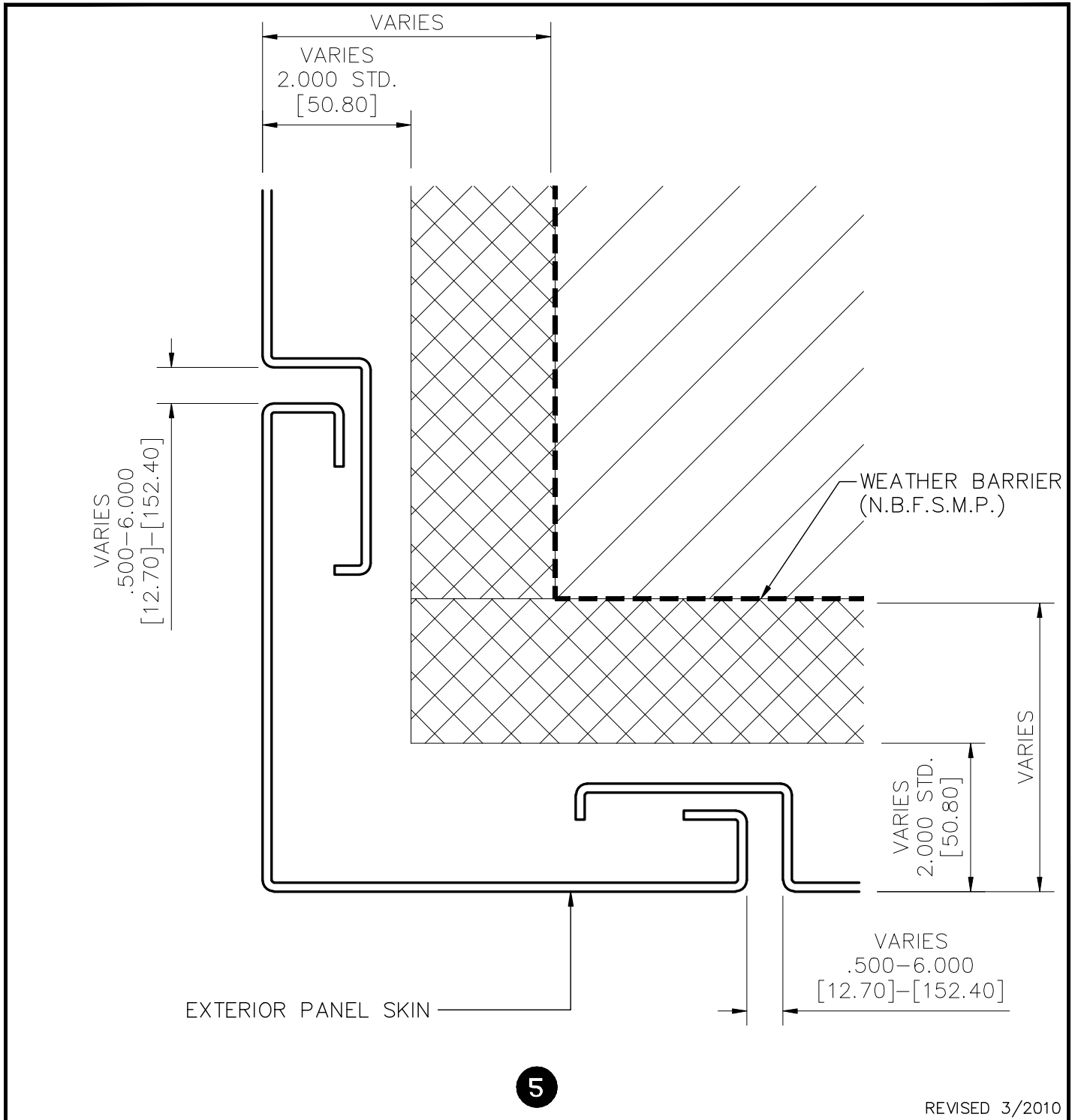

SERIES 4500 - SOFFIT DETAIL

S4500-06

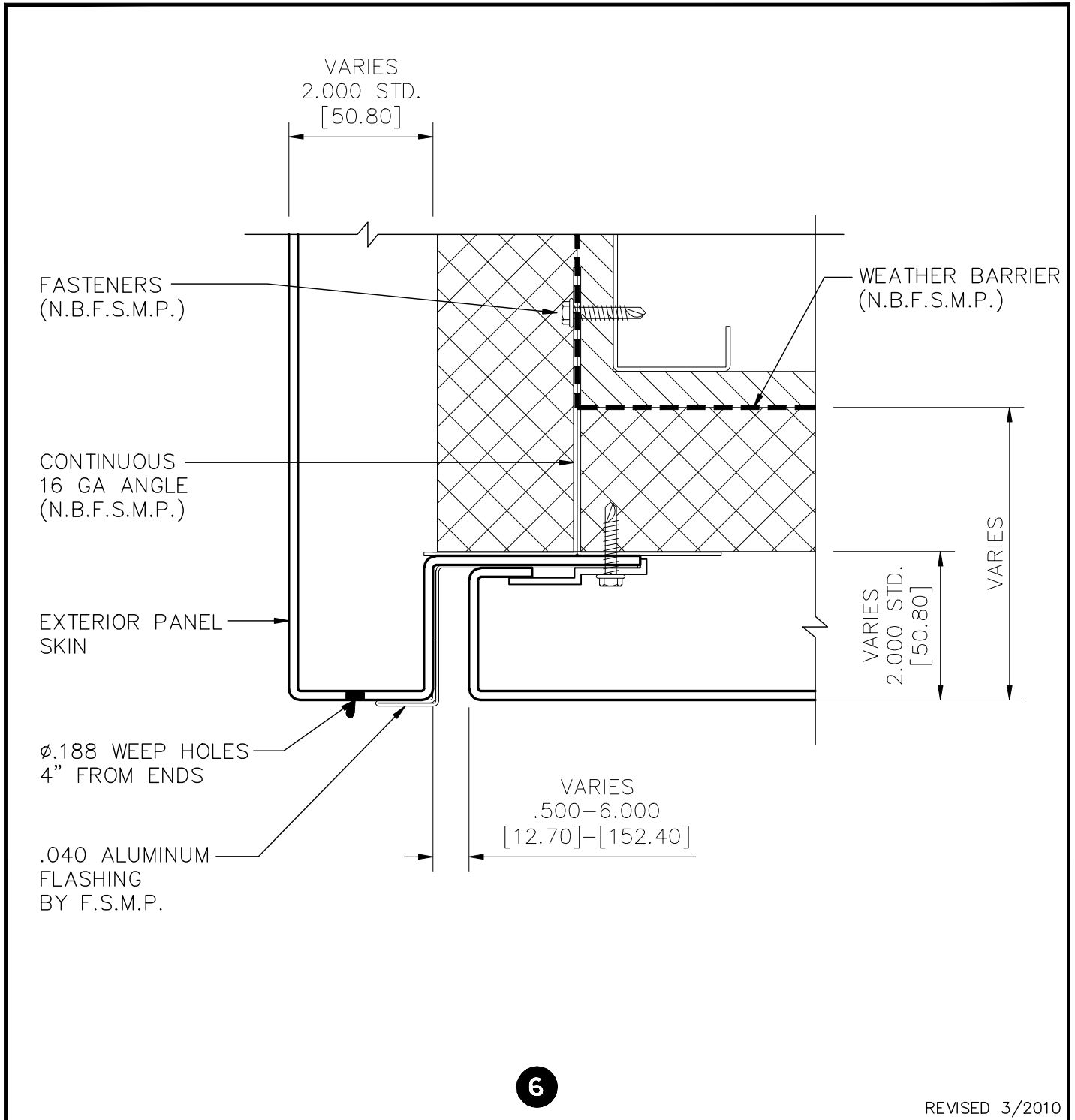

SERIES 4500 - WINDOW JAMB DETAIL

S4500-07

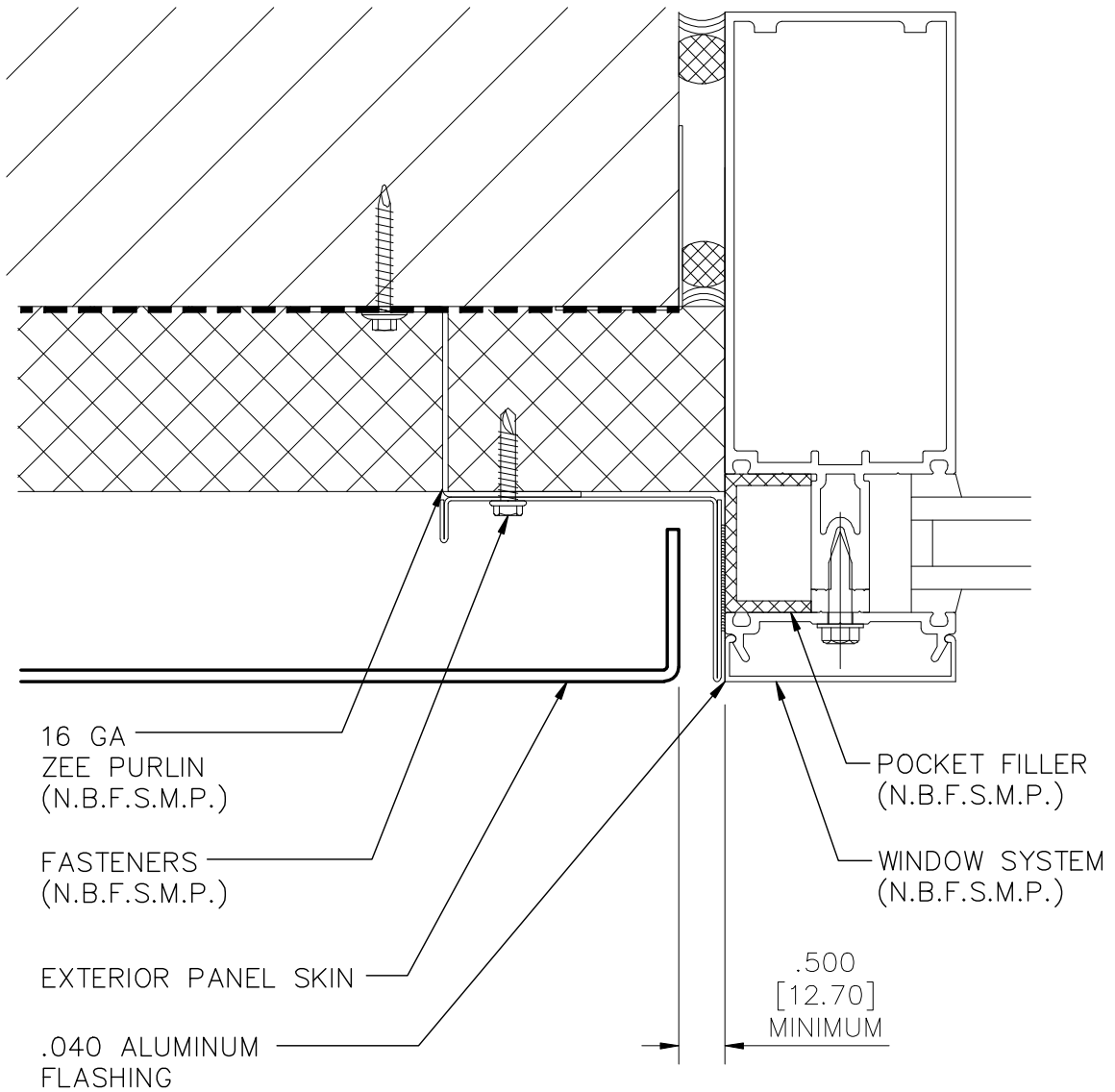

7

REVISED 3/2010

SERIES 4500 - WINDOW HEAD DETAIL S4500-08

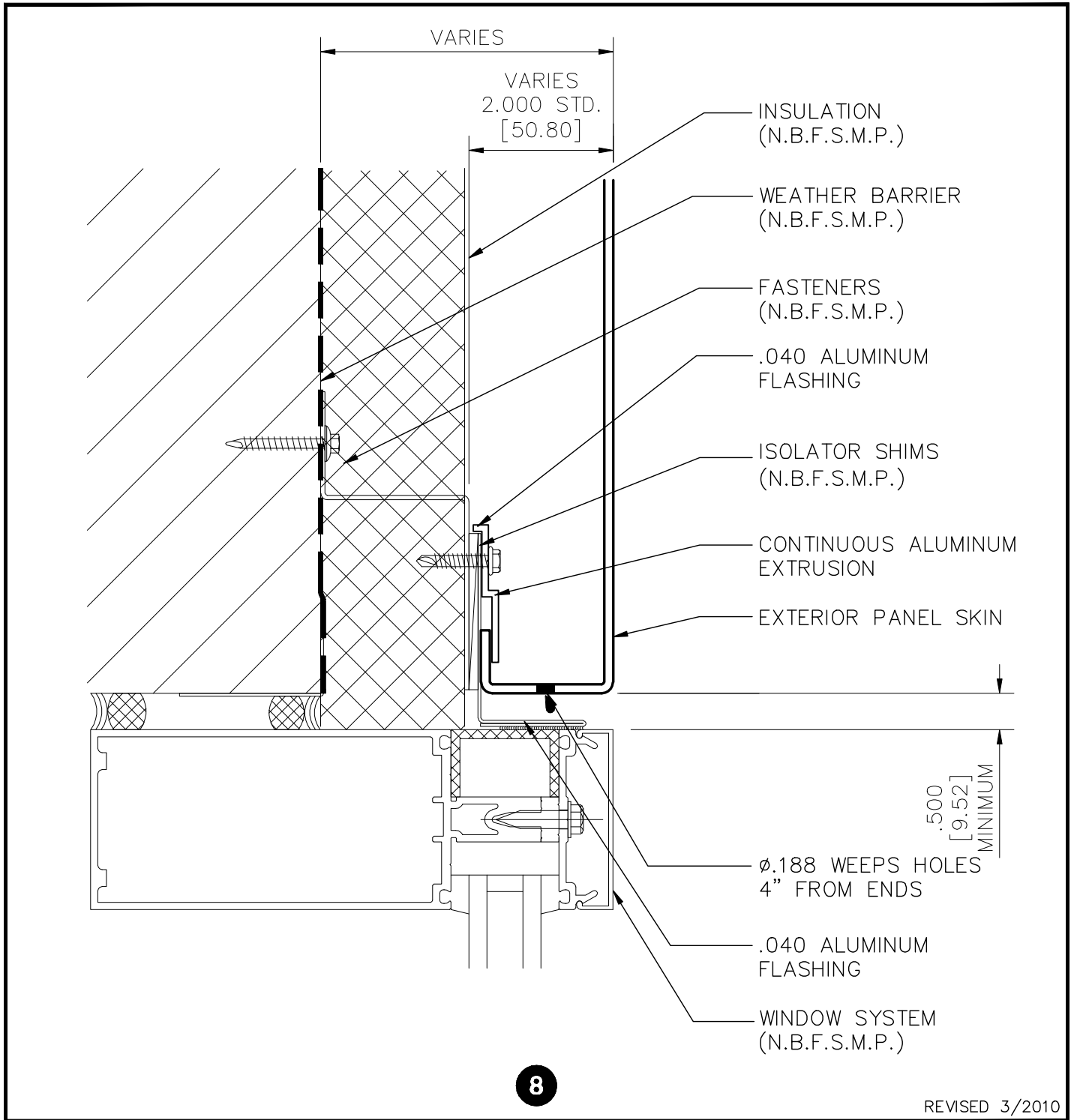

SERIES 4500 - WINDOW SILL DETAIL

S4500-09

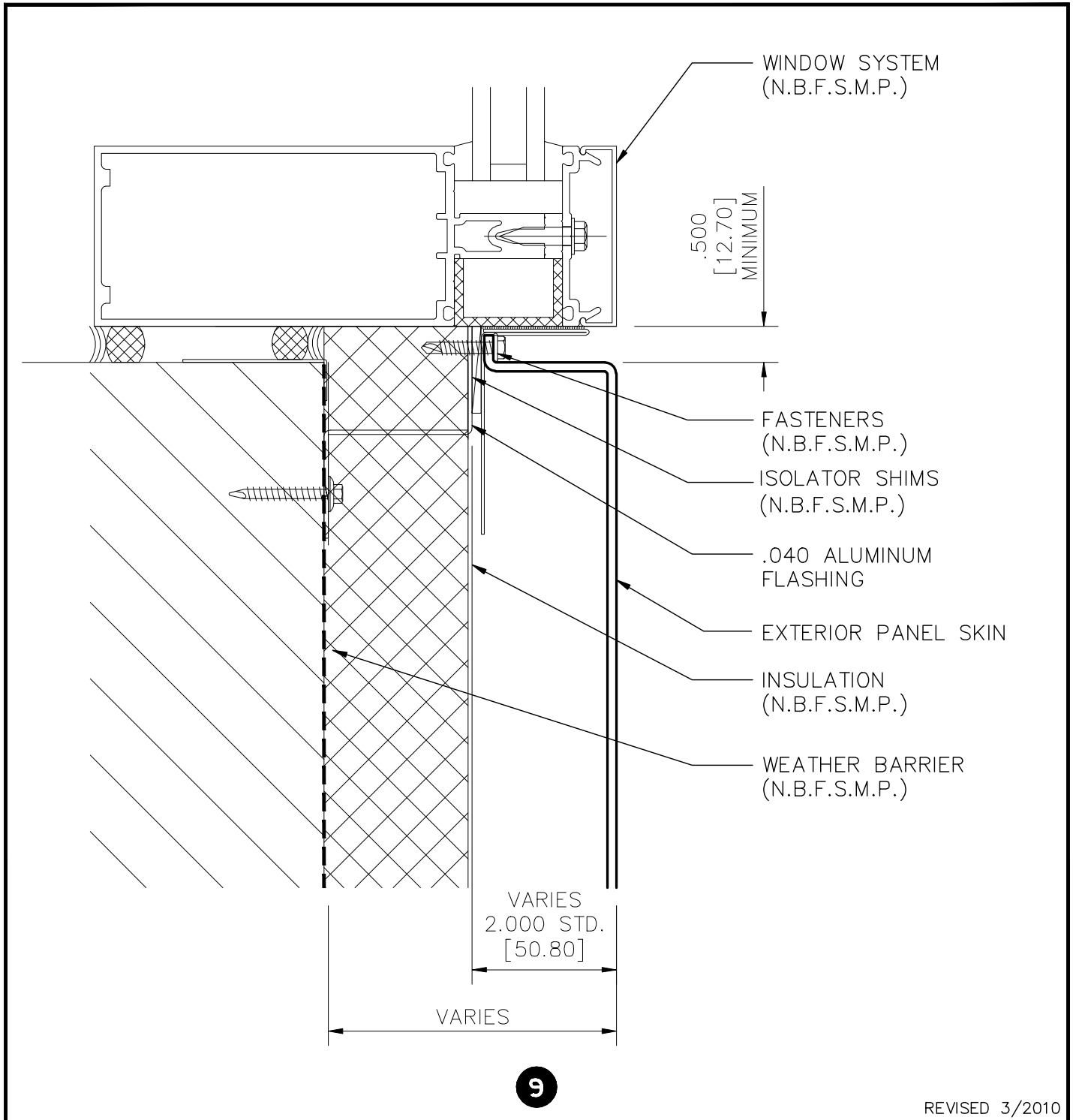

SERIES 4500 - BASE DETAIL

S4500-10

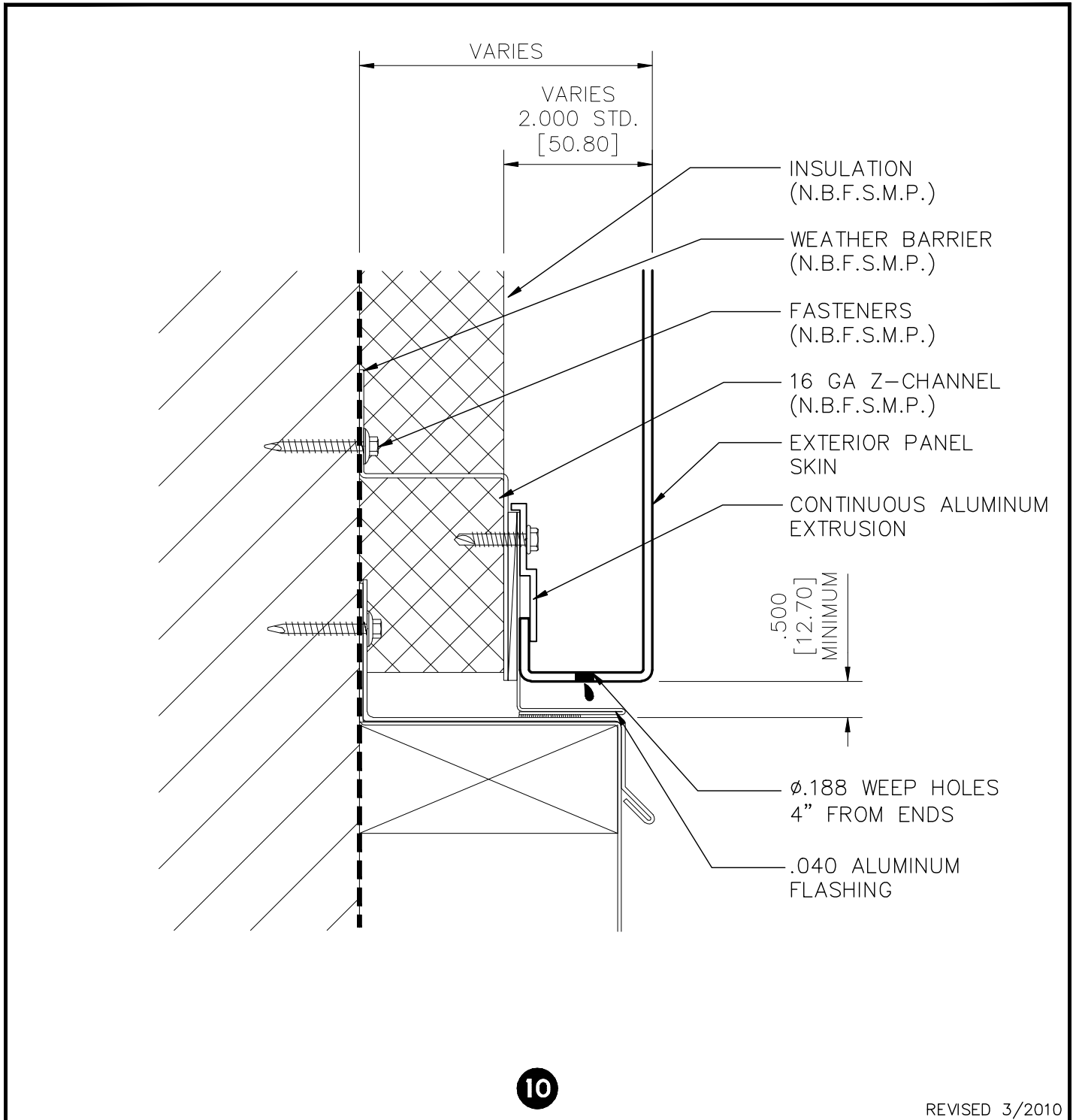

SERIES 4500 - INSIDE CORNER DETAIL S4500-11

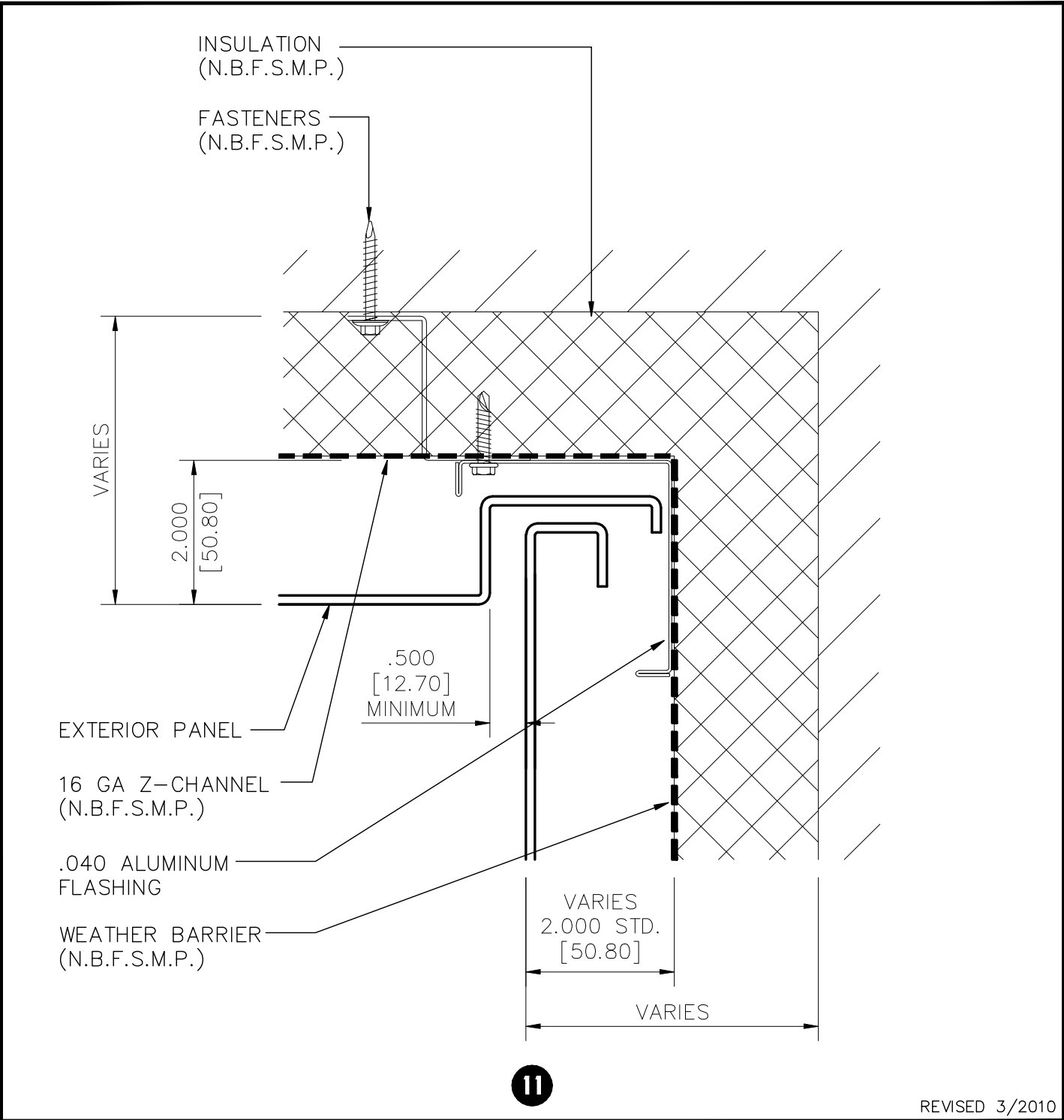



1-800-426-7737

WWW.UNACLAD.COM

Series 4500

UNA-CLAD Panel

DESCRIPTION

High performance system of aluminum plate or natural metal. System is attached with continuous horizontal cleats and a guttered vertical jointer.

FEATURES

- flatness
- flexible design parameters
- excellent interface with surrounding construction
- complex shapes
- guttered and weeped system design
- vertical joint sequential installation

MATERIAL OPTIONS

- .063 to .125 metal thickness in aluminum
- natural metals

FABRICATION OPTIONS

- corners welded and ground smooth (painted)
- corners back welded or sealed (painted or anodized)

FINISH OPTIONS

- Kynar 500®/Hylar 5000® high performance fluorocarbon resinous coatings
- class I and II batch anodized

LIMITATIONS

- maximum narrow dimension of 52 inches