

**SERIES 10 - UNA-CLAD PANEL INDEX**

**S10-00**

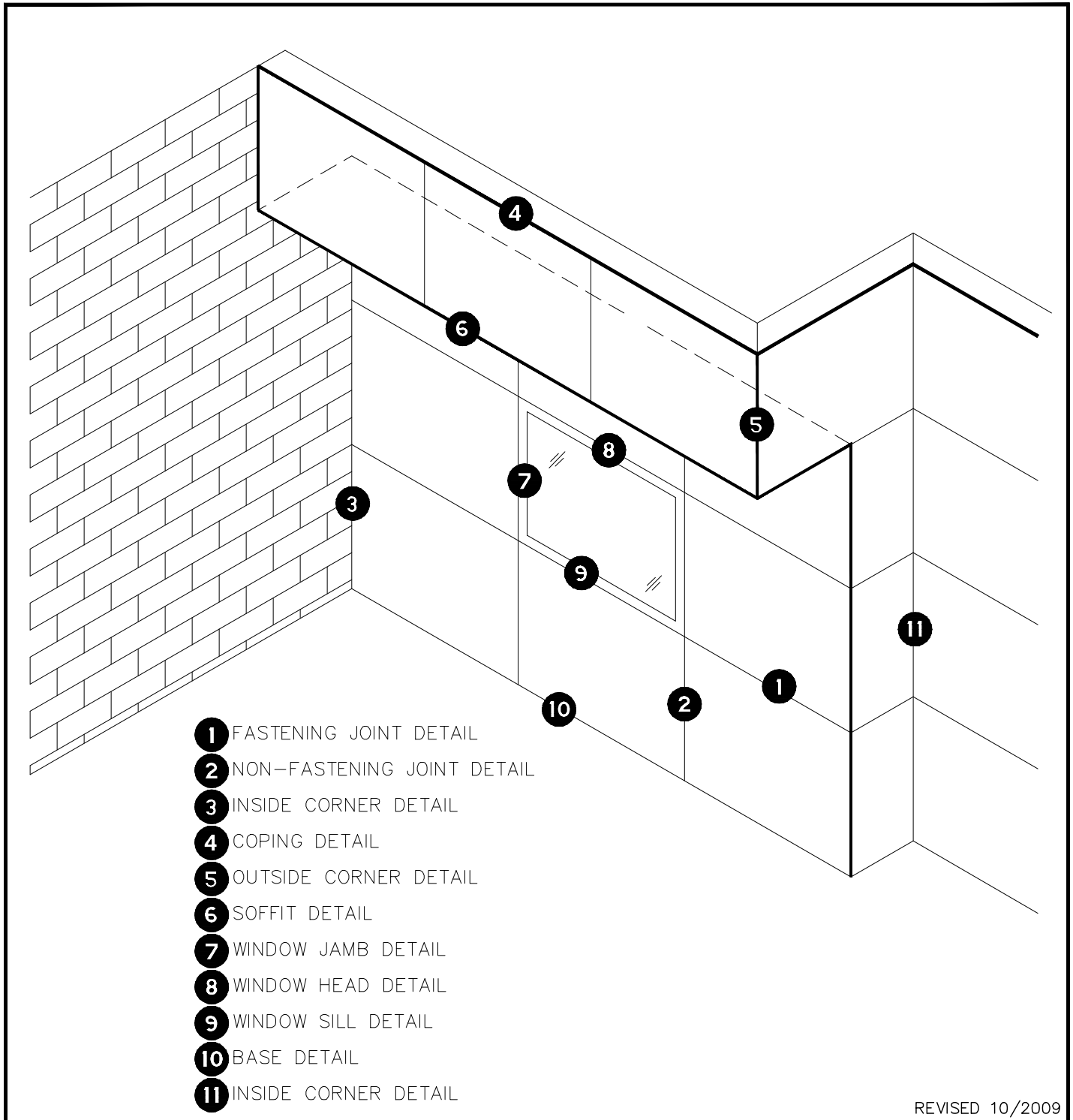

**SERIES 10 - FASTENING JOINT DETAIL**

**S10-01**

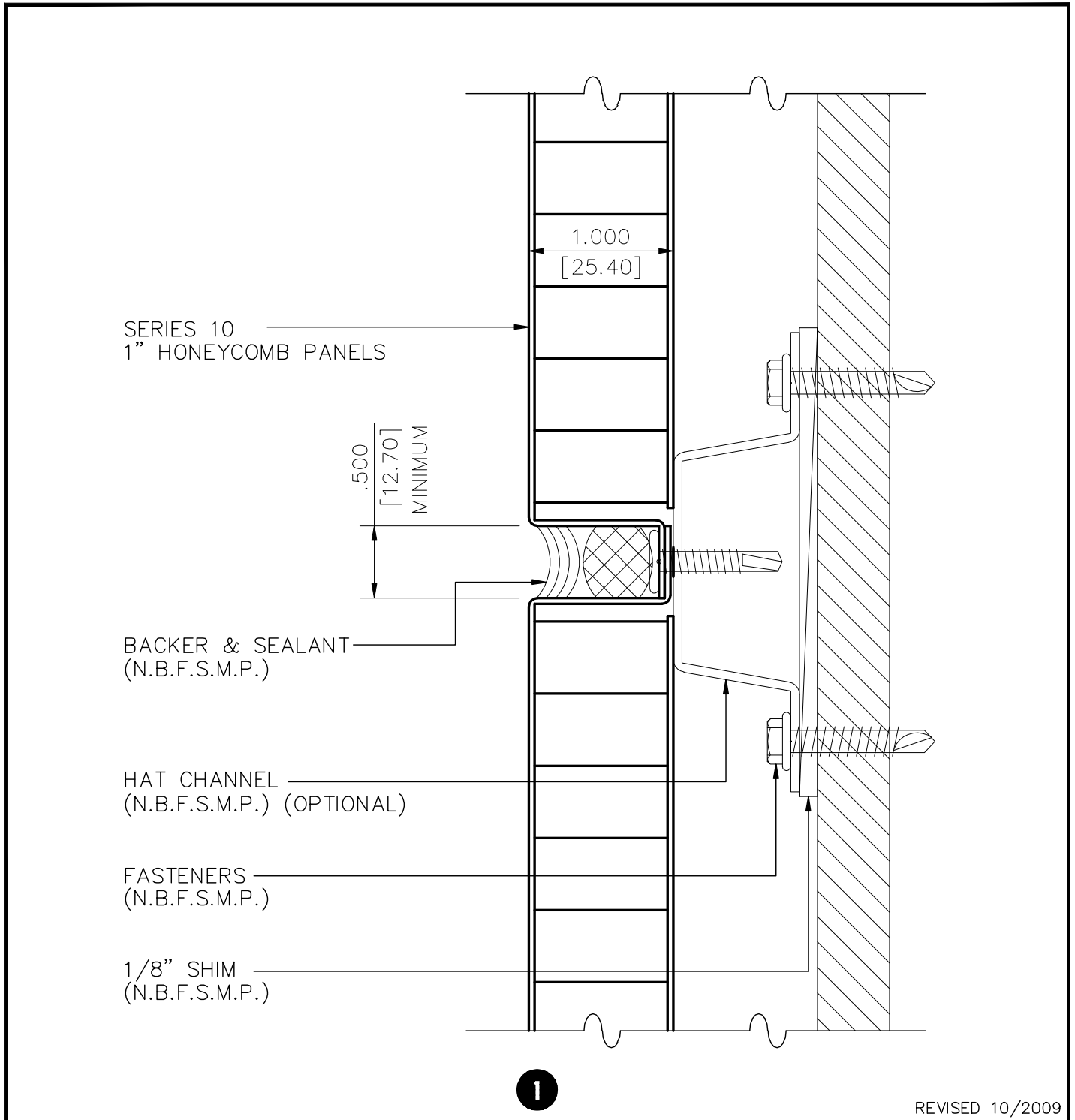

**SERIES 10 - NON-FASTENING JOINT DETAIL**

**S10-02**

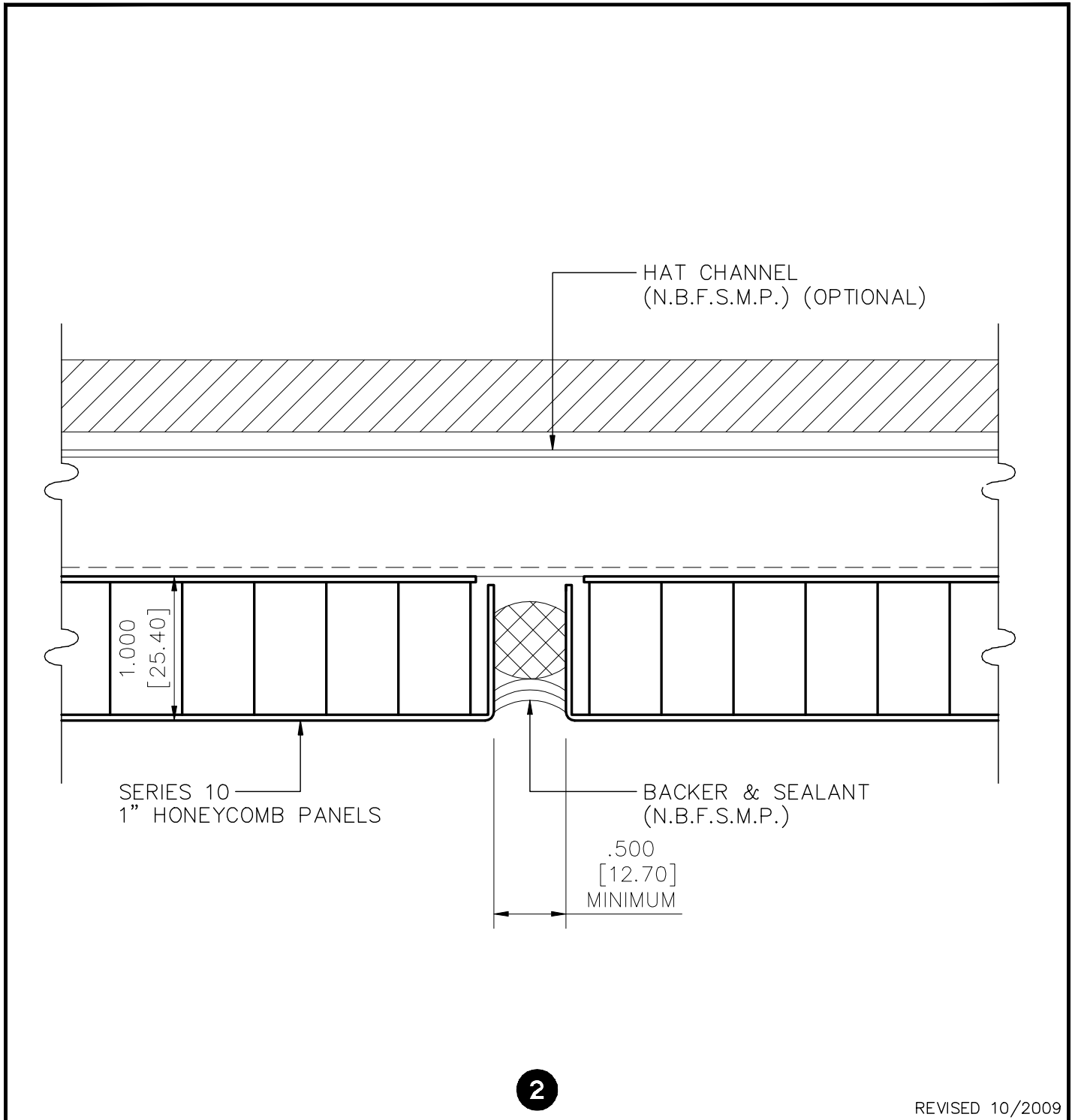

**SERIES 10 - INSIDE CORNER DETAIL**

**S10-03**

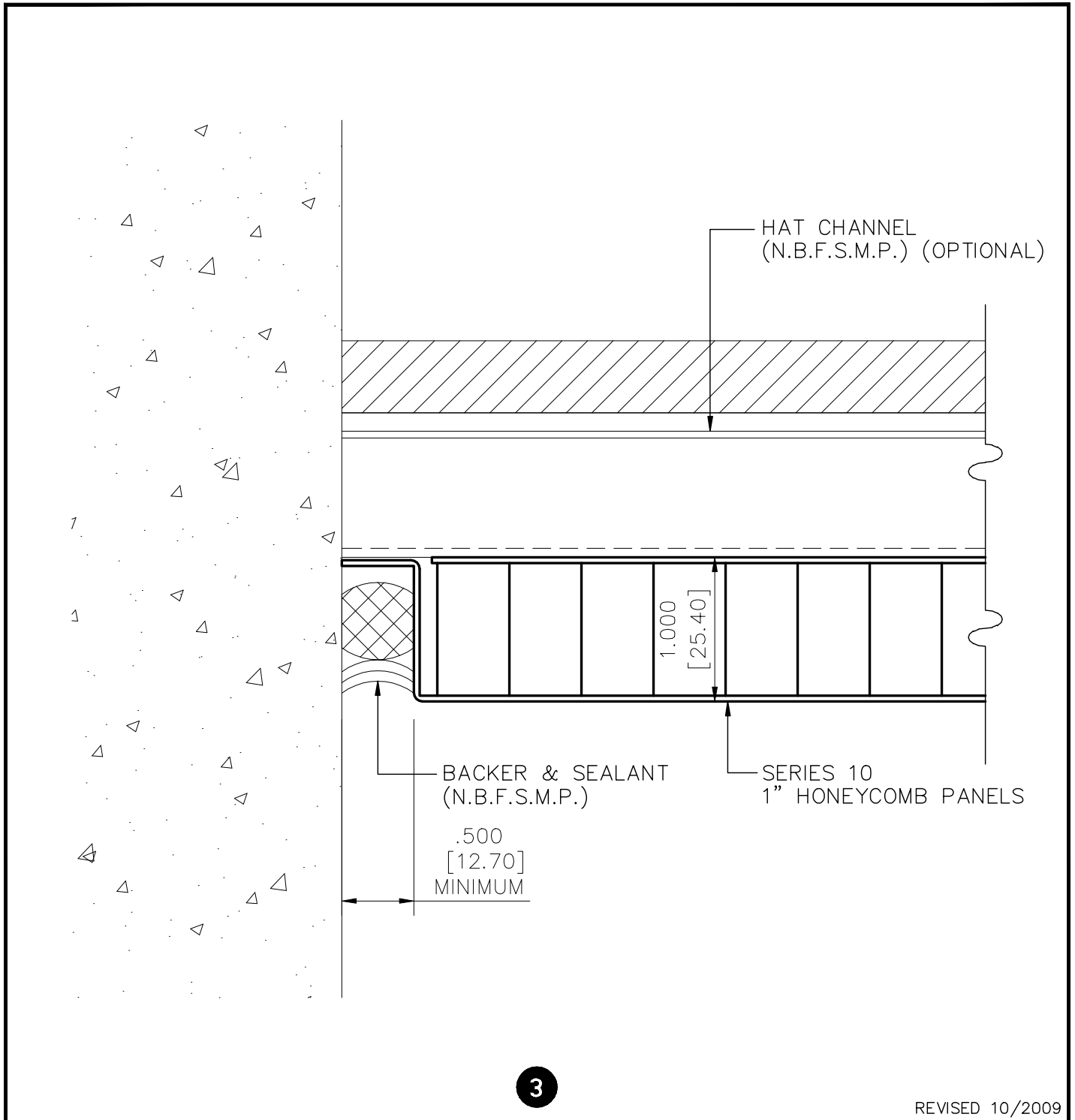

**SERIES 10 - COPING DETAIL**

**S10-04**

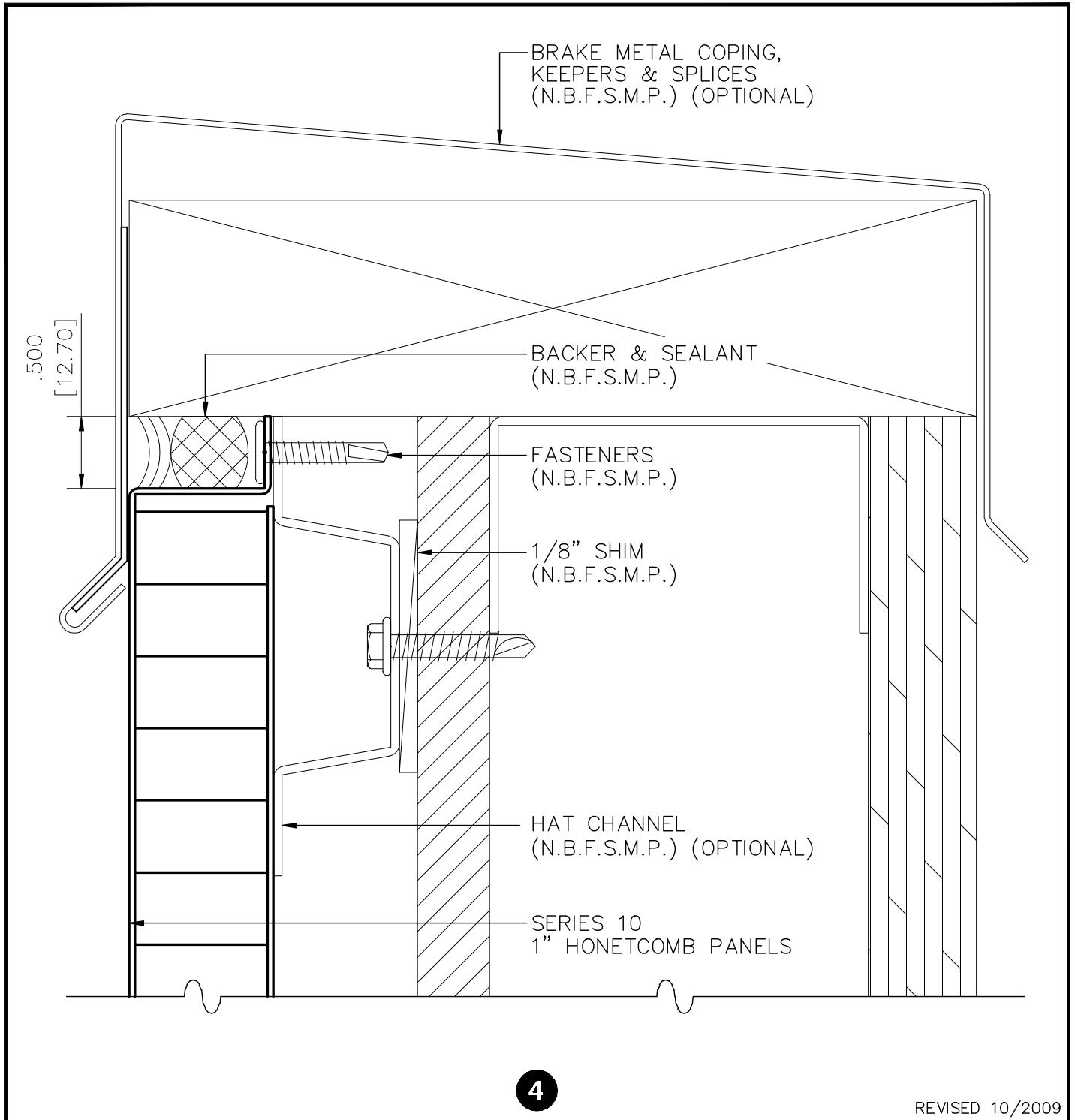

**SERIES 10 - OUTSIDE CORNER DETAIL**

**S10-05A**

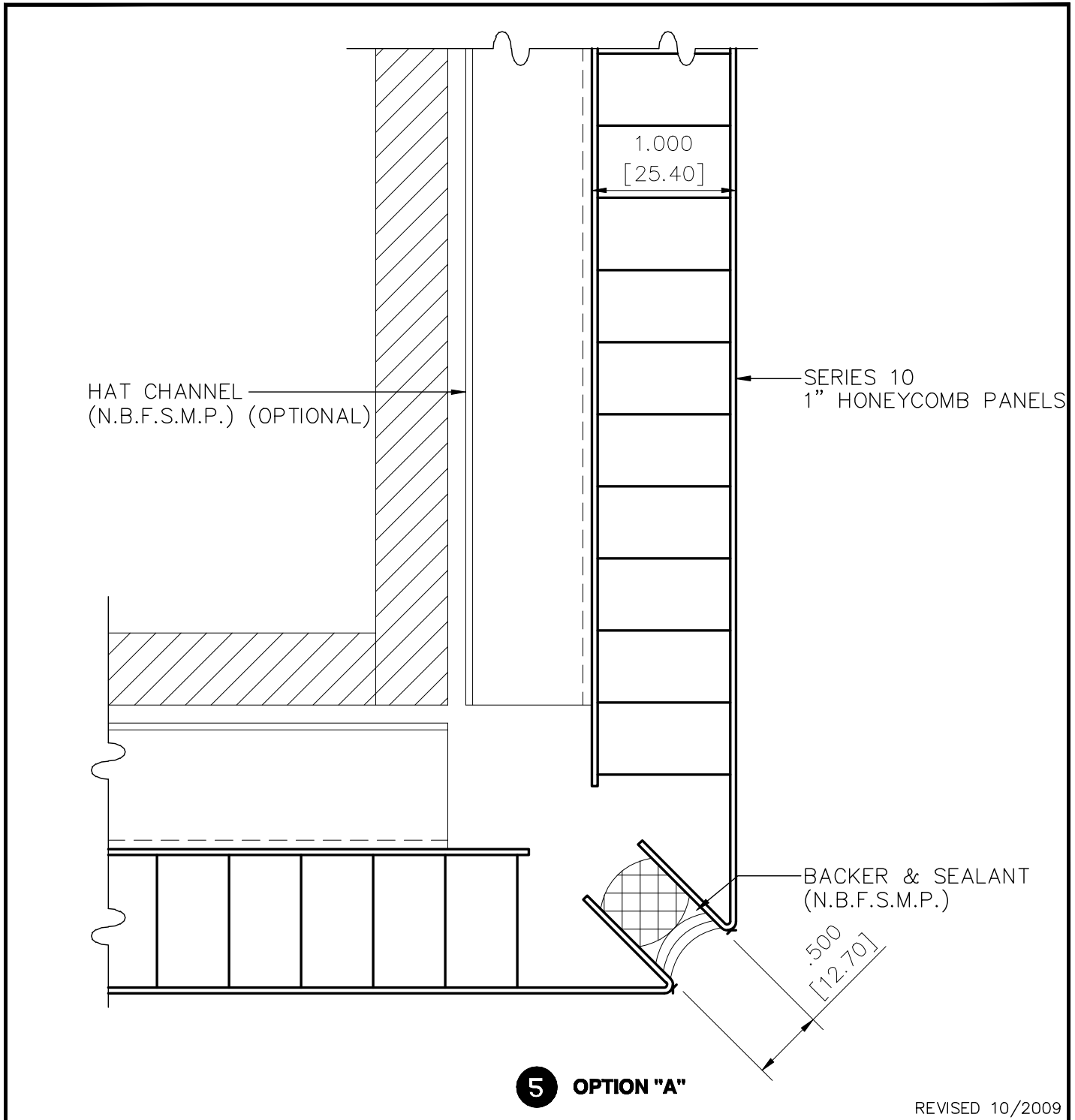

**SERIES 10 - OUTSIDE CORNER DETAIL**

**S10-05**

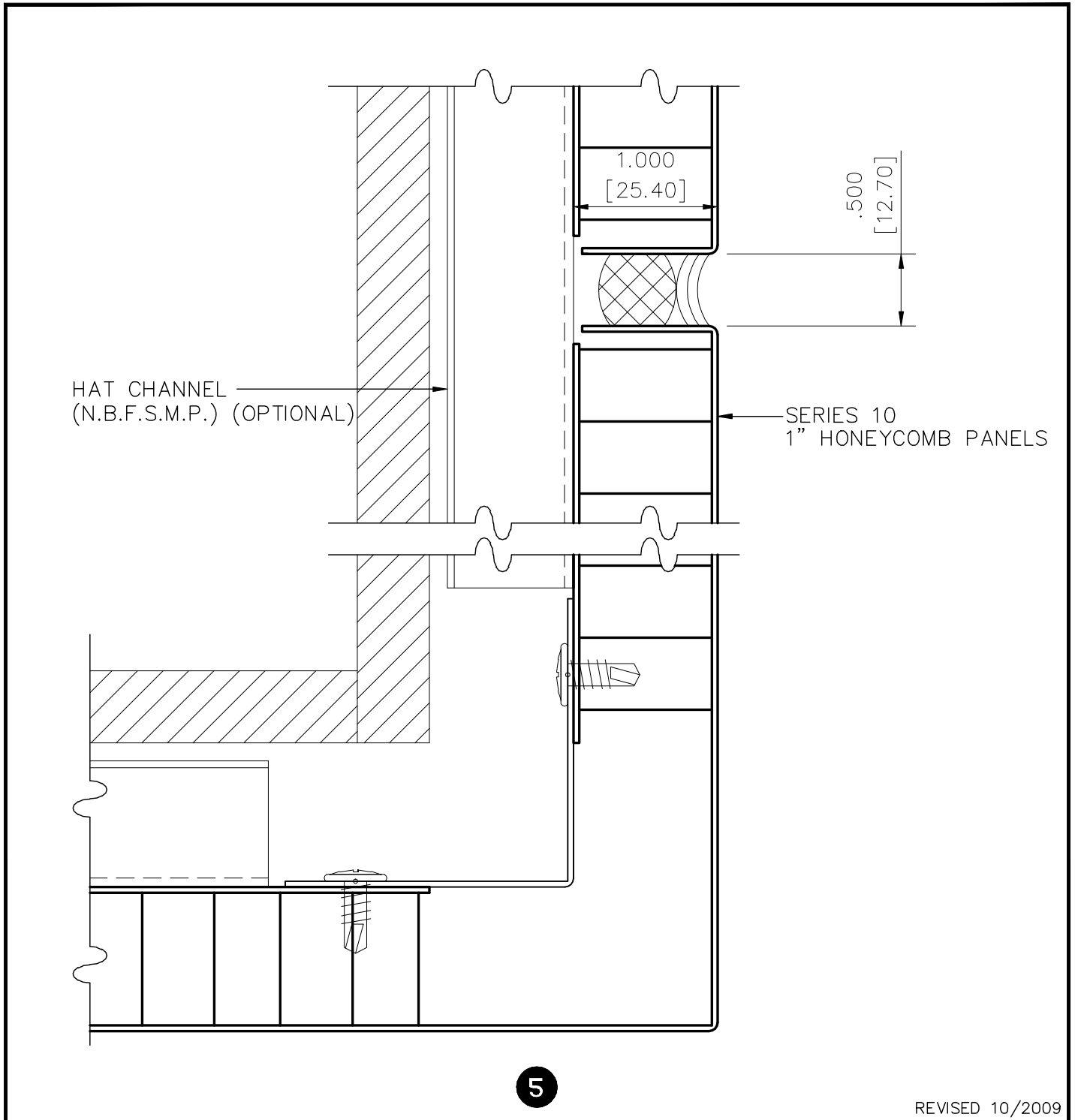

**SERIES 10 - SOFFIT DETAIL S10-06**

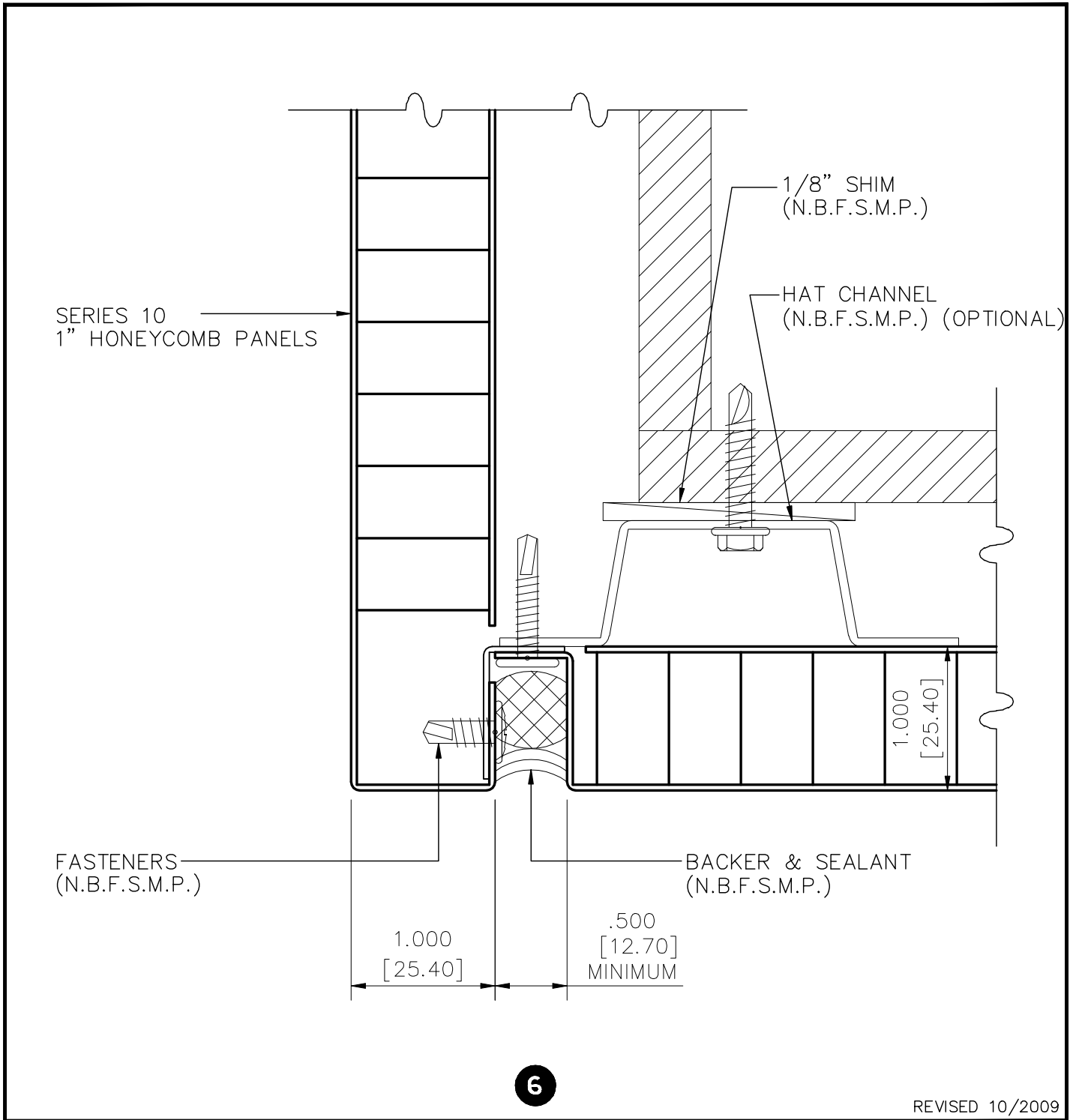

**SERIES 10 - WINDOW JAMB DETAIL S10-07**

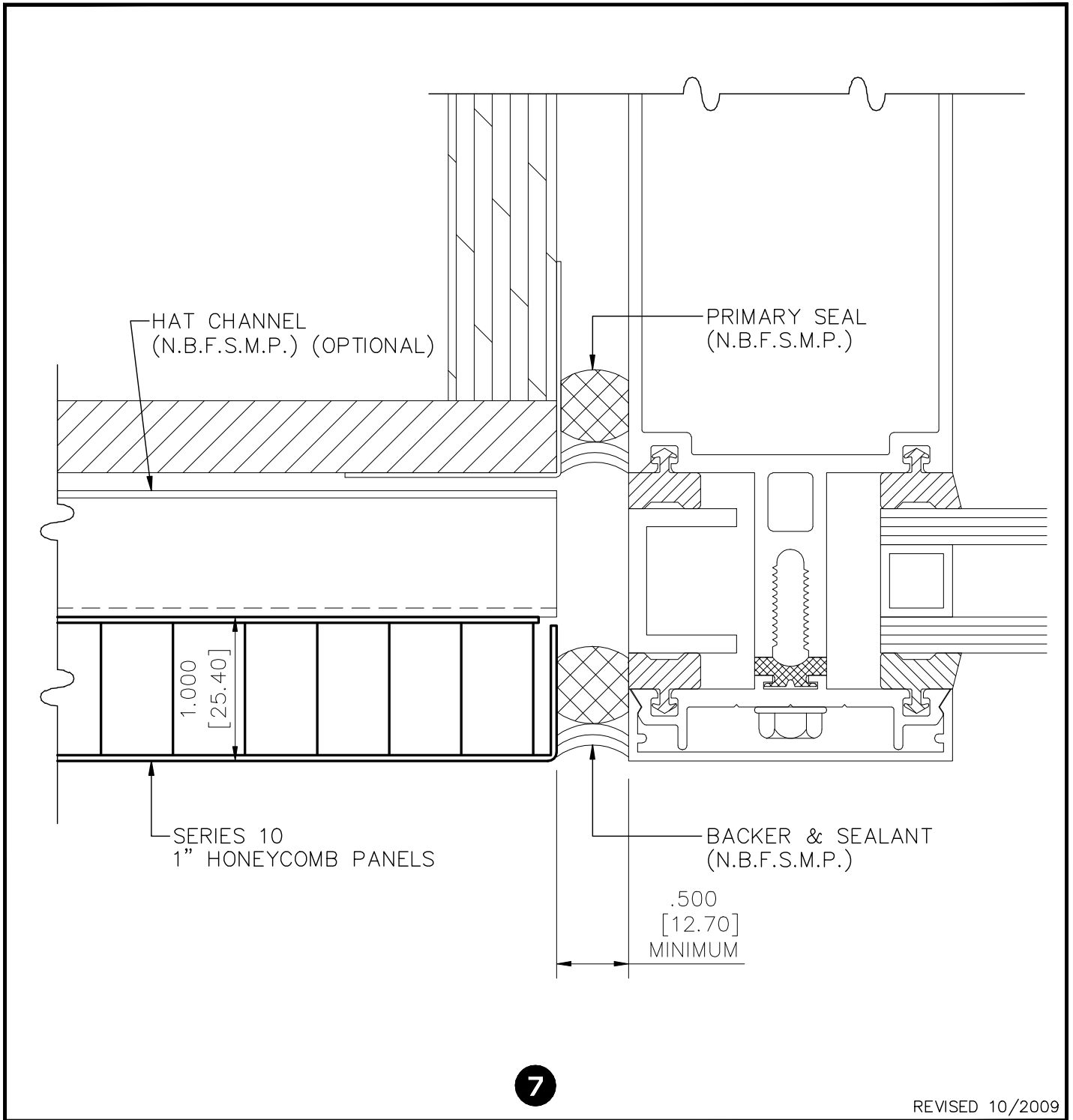

**SERIES 10 - WINDOW HEAD DETAIL**

**S10-08**

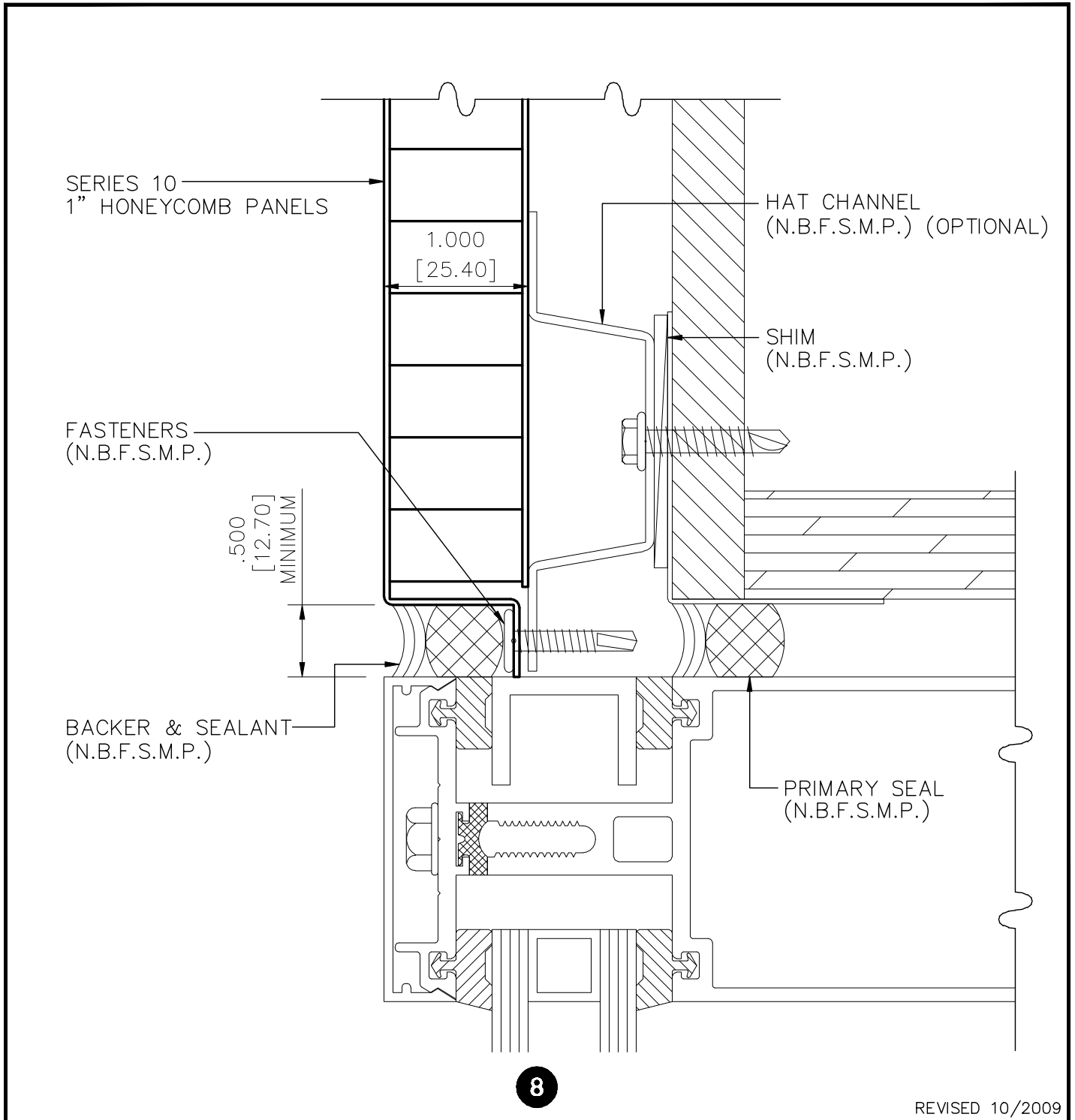

**SERIES 10 - WINDOW SILL DETAIL**

**S10-09**

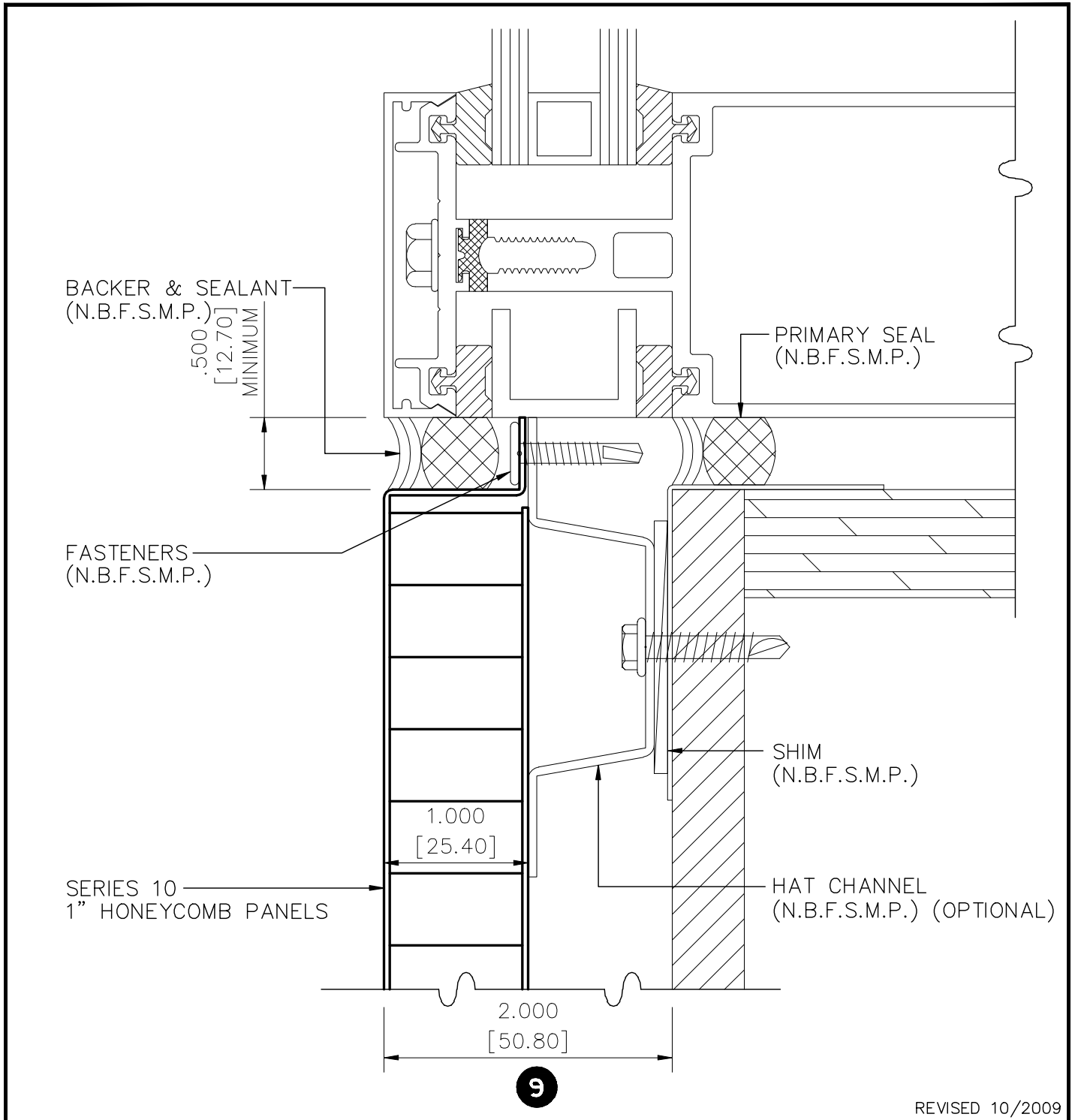

**SERIES 10 - BASE DETAIL**

**S10-10**

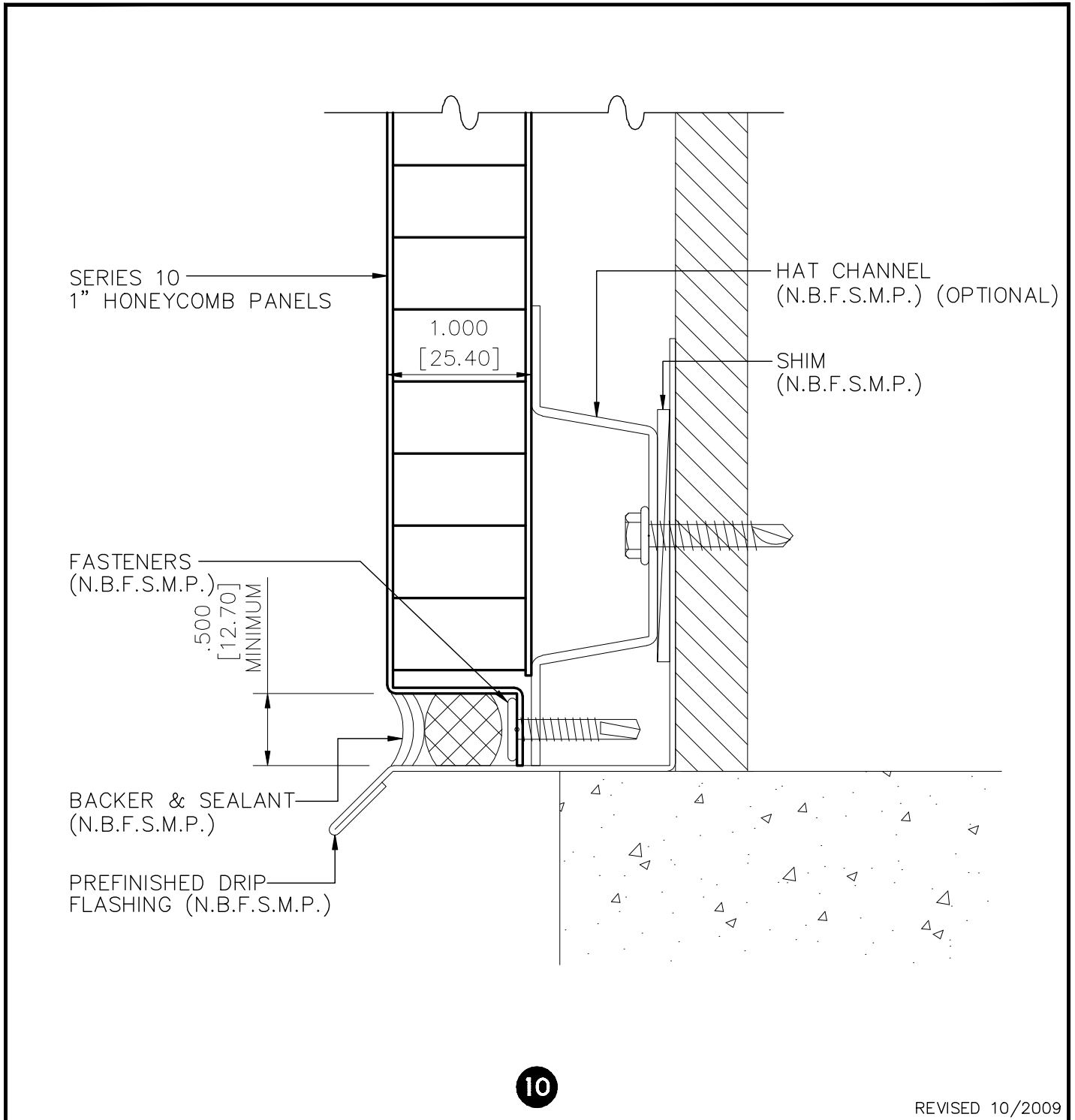

**SERIES 10 - INSIDE CORNER DETAIL**

**S10-11A**

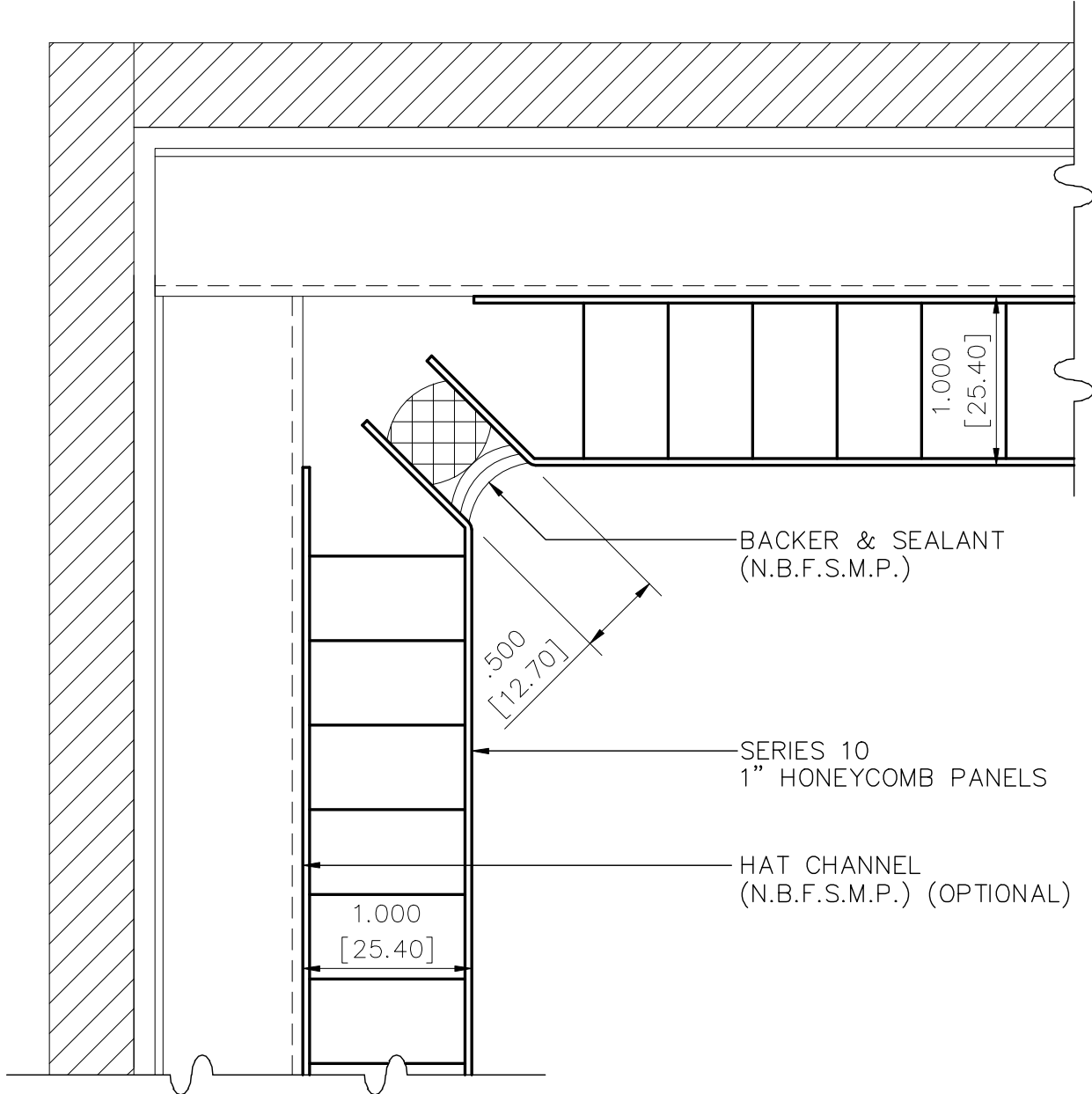

**11** **OPTION "A"**

REVISED 10/2009

**SERIES 10 - INSIDE CORNER DETAIL**

**S10-11**

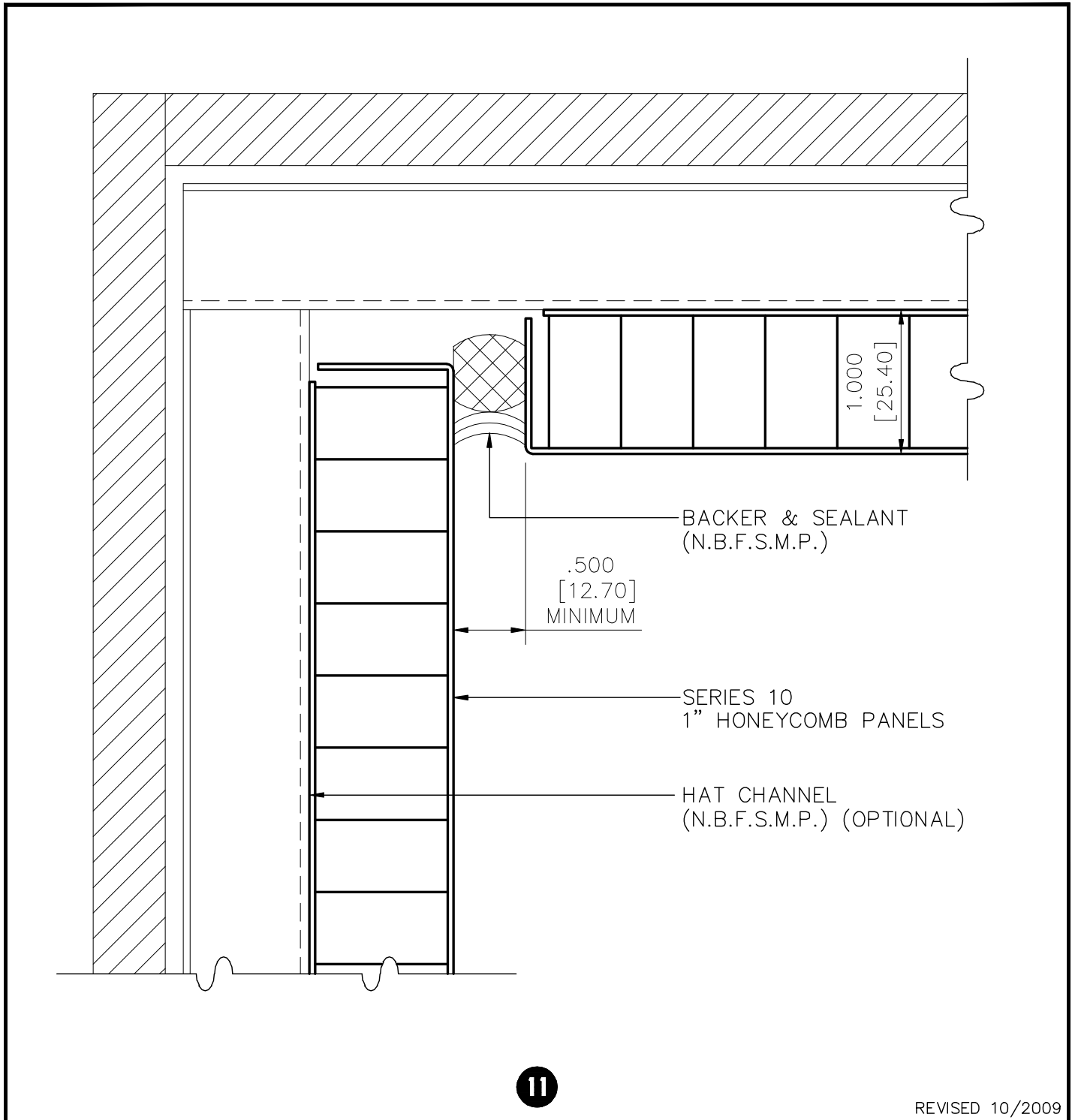



1-800-426-7737

WWW.UNACLAD.COM

## Series 10 UNA-CLAD Panel

### DESCRIPTION

Aluminum or stainless steel skins laminated to aluminum or kraft paper honeycomb core material. System is mechanically attached with caulked joints and installed in a non-sequential pattern.

### FEATURES

- flatness
- superb deflection resistance
- very lightweight
- special reveals
- non-sequential installation
- irregular-shaped panels

### MATERIAL OPTIONS

- coil-coated aluminum skins (.40 or .063)
- post-painted aluminum skins (short run, custom colors) .063 to .125
- stainless steel skins (kraft paper only)
- panel thickness from 1/4 to 3 inches

### FINISH OPTIONS

- Kynar 500®/Hylar 5000® high performance fluorocarbon resinous coatings
- coil anodized
- batch anodized
- stainless steel with #4 brushed-satin and #8 mirror-polished finish
- fluoropolymer high gloss finish
- special coatings

### LIMITATIONS

- Maximum narrow dimension is 58 inches (for 1-inch panels)