

**SERIES 2000 UNA-CLAD PANEL INDEX**

**S2000-00**

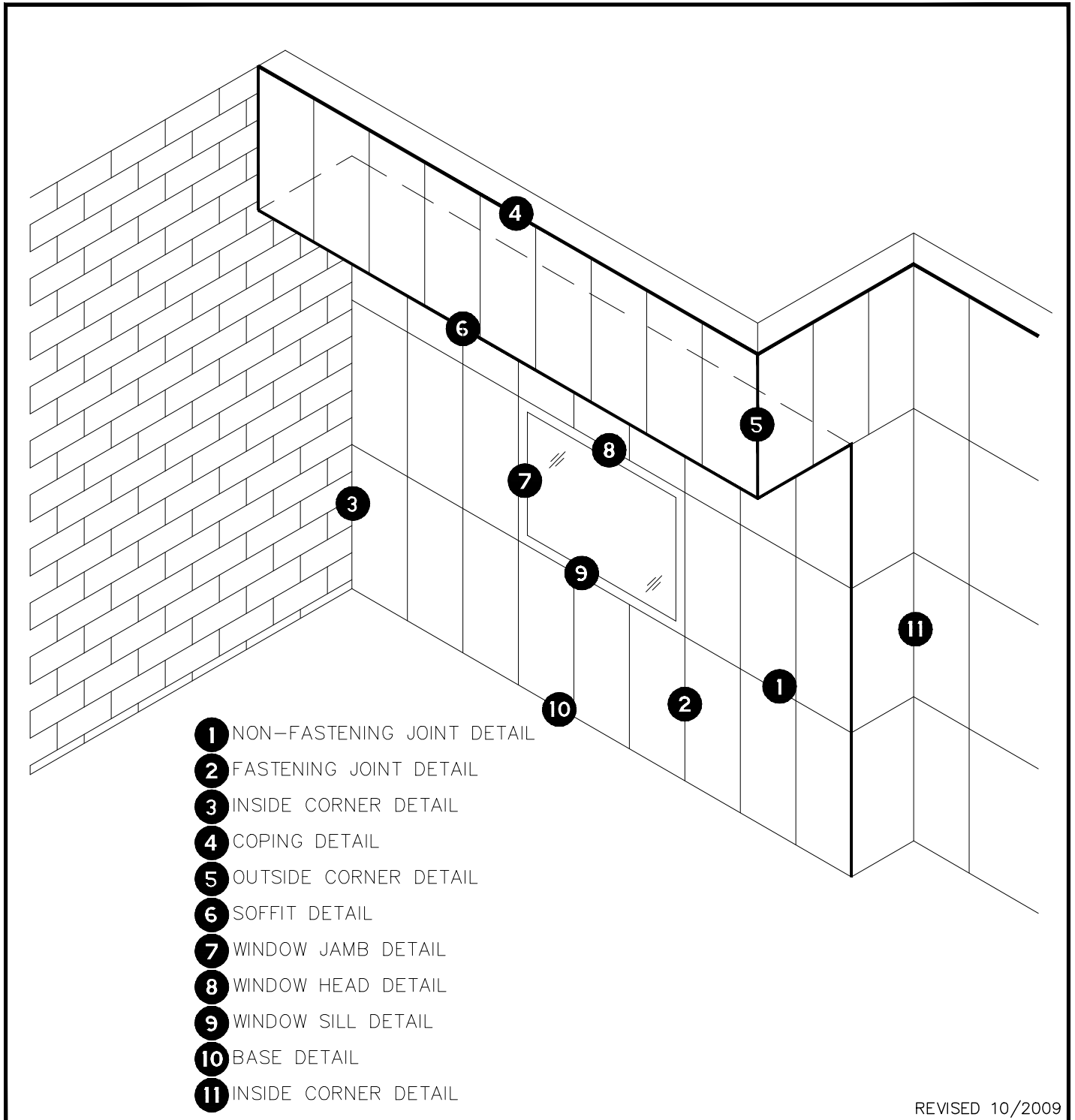

- 1 NON-FASTENING JOINT DETAIL
- 2 FASTENING JOINT DETAIL
- 3 INSIDE CORNER DETAIL
- 4 COPING DETAIL
- 5 OUTSIDE CORNER DETAIL
- 6 SOFFIT DETAIL
- 7 WINDOW JAMB DETAIL
- 8 WINDOW HEAD DETAIL
- 9 WINDOW SILL DETAIL
- 10 BASE DETAIL
- 11 INSIDE CORNER DETAIL

REVISED 10/2009

**SERIES 2000 - NON-FASTENING JOINT DETAIL S2000-01**

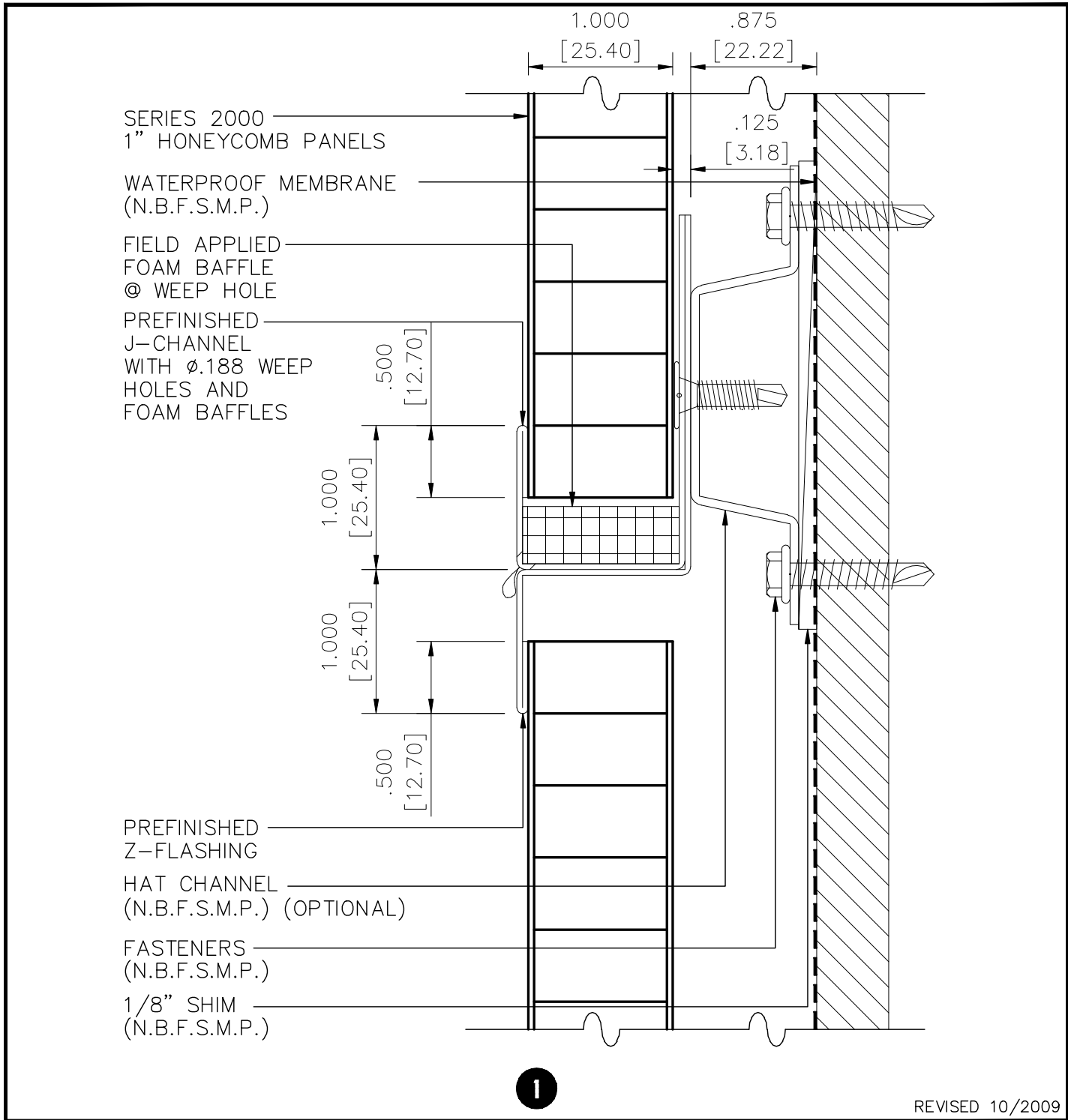

**SERIES 2000 - FASTENING JOINT DETAIL**

**S2000-02**

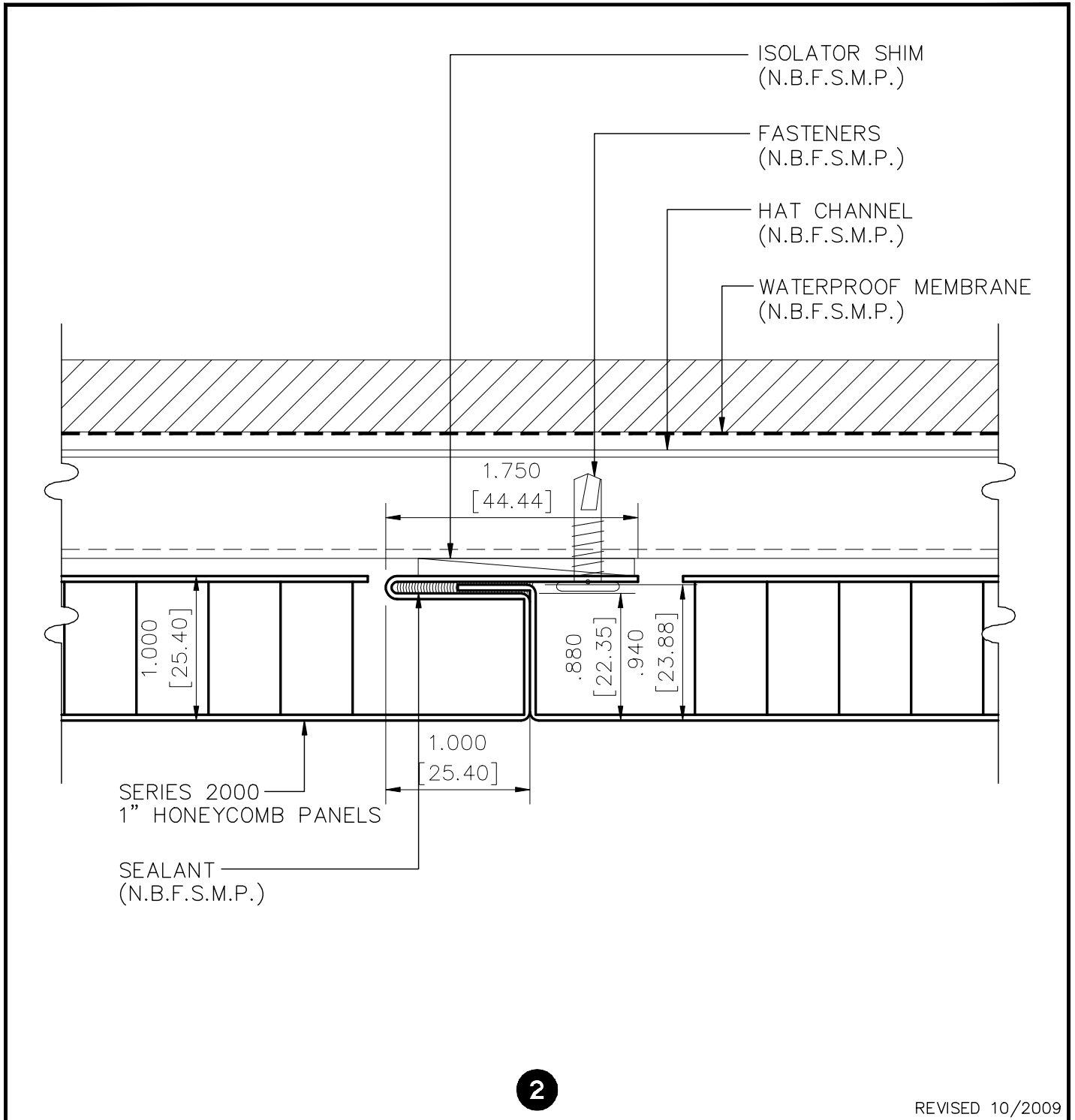

**SERIES 2000 - INSIDE CORNER DETAIL S2000-03**

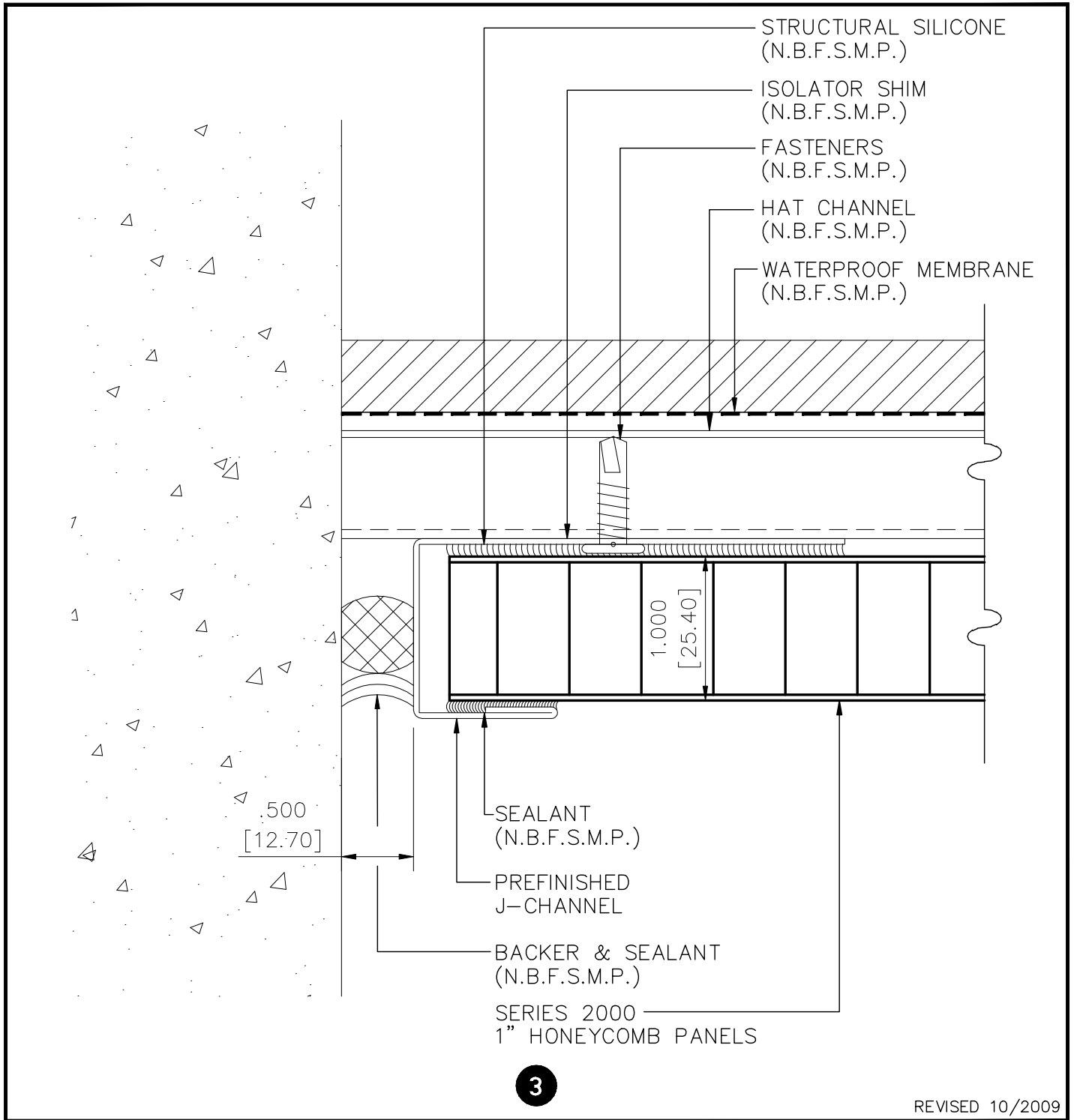

**SERIES 2000 - COPING DETAIL**

**S2000-04**

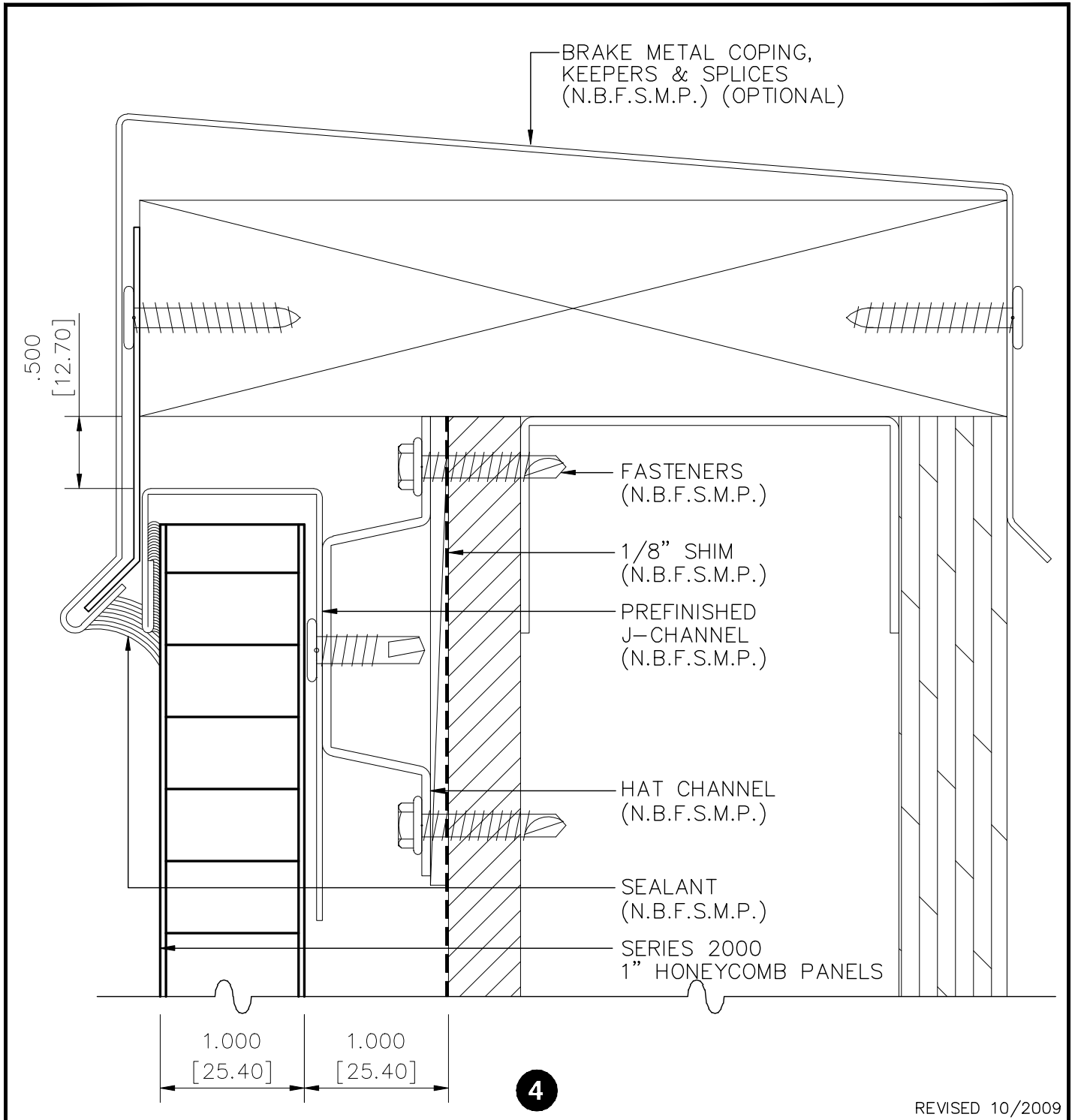

**SERIES 2000 - OUTSIDE CORNER DETAIL**

**S2000-05**

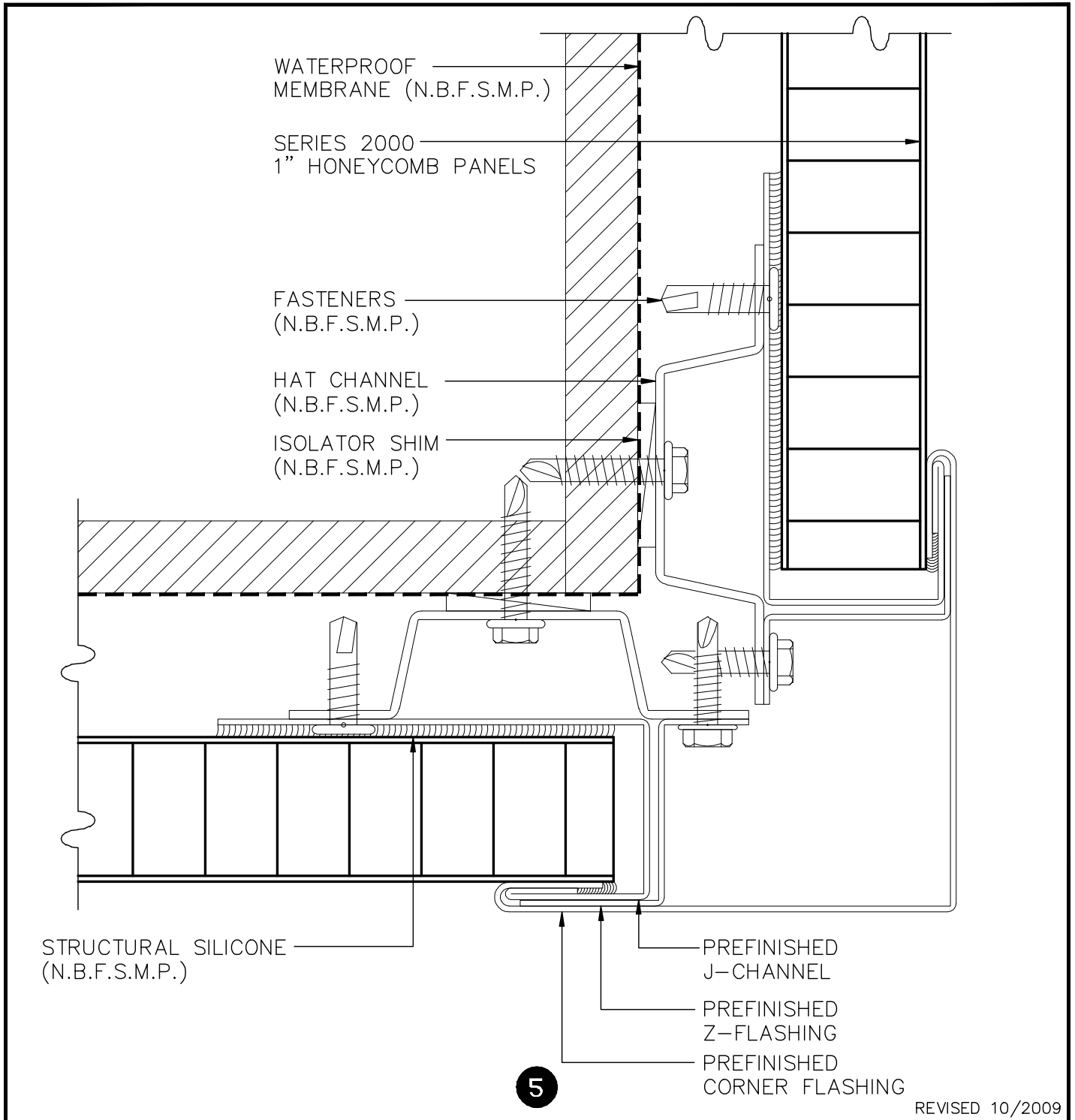

**SERIES 2000 - SOFFIT DETAIL S2000-06**

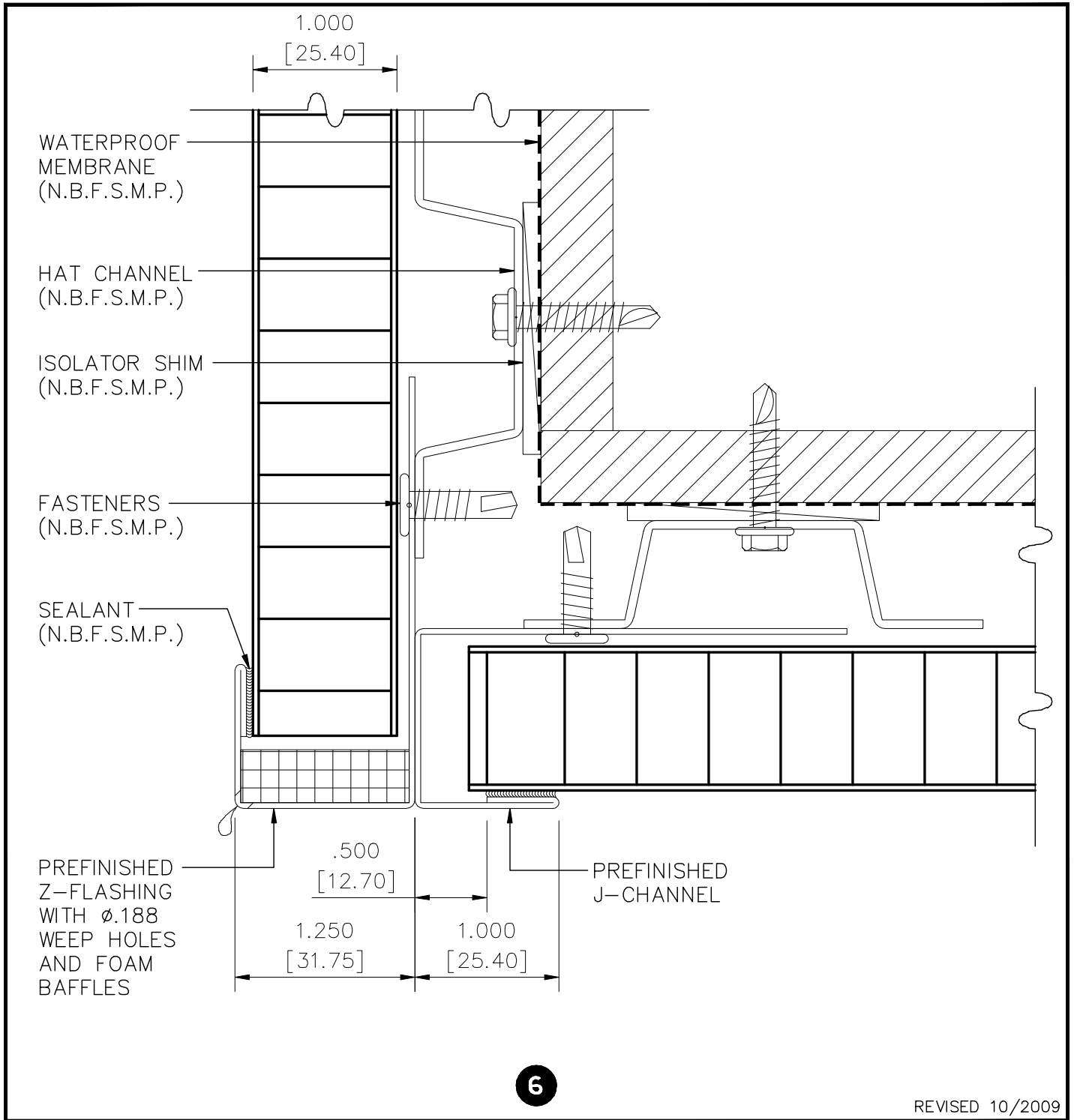

**SERIES 2000 - WINDOW JAMB DETAIL S2000-07**

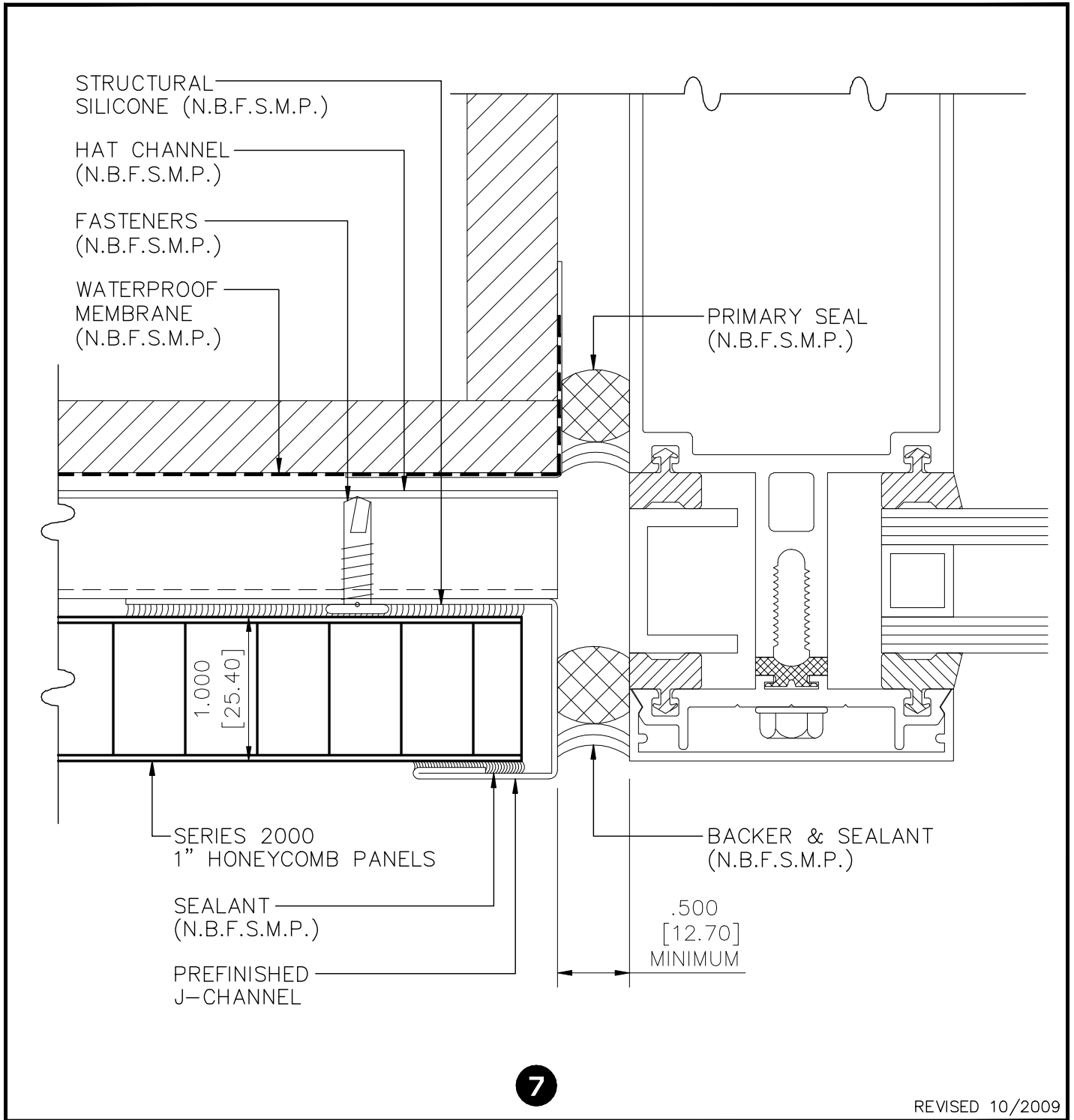

**SERIES 2000 - WINDOW HEAD DETAIL S2000-08**

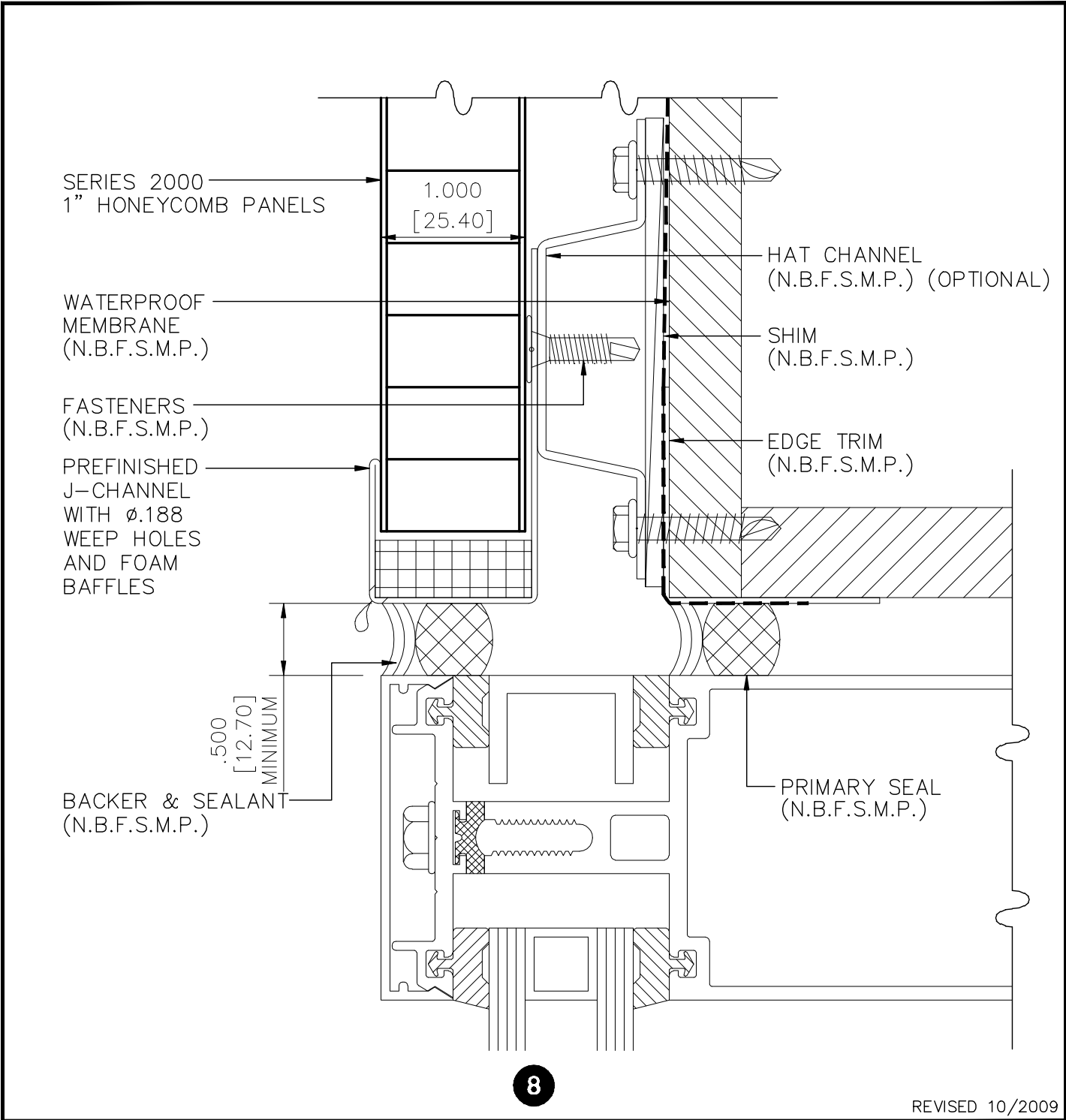

**SERIES 2000 - WINDOW SILL DETAIL**

**S2000-09**

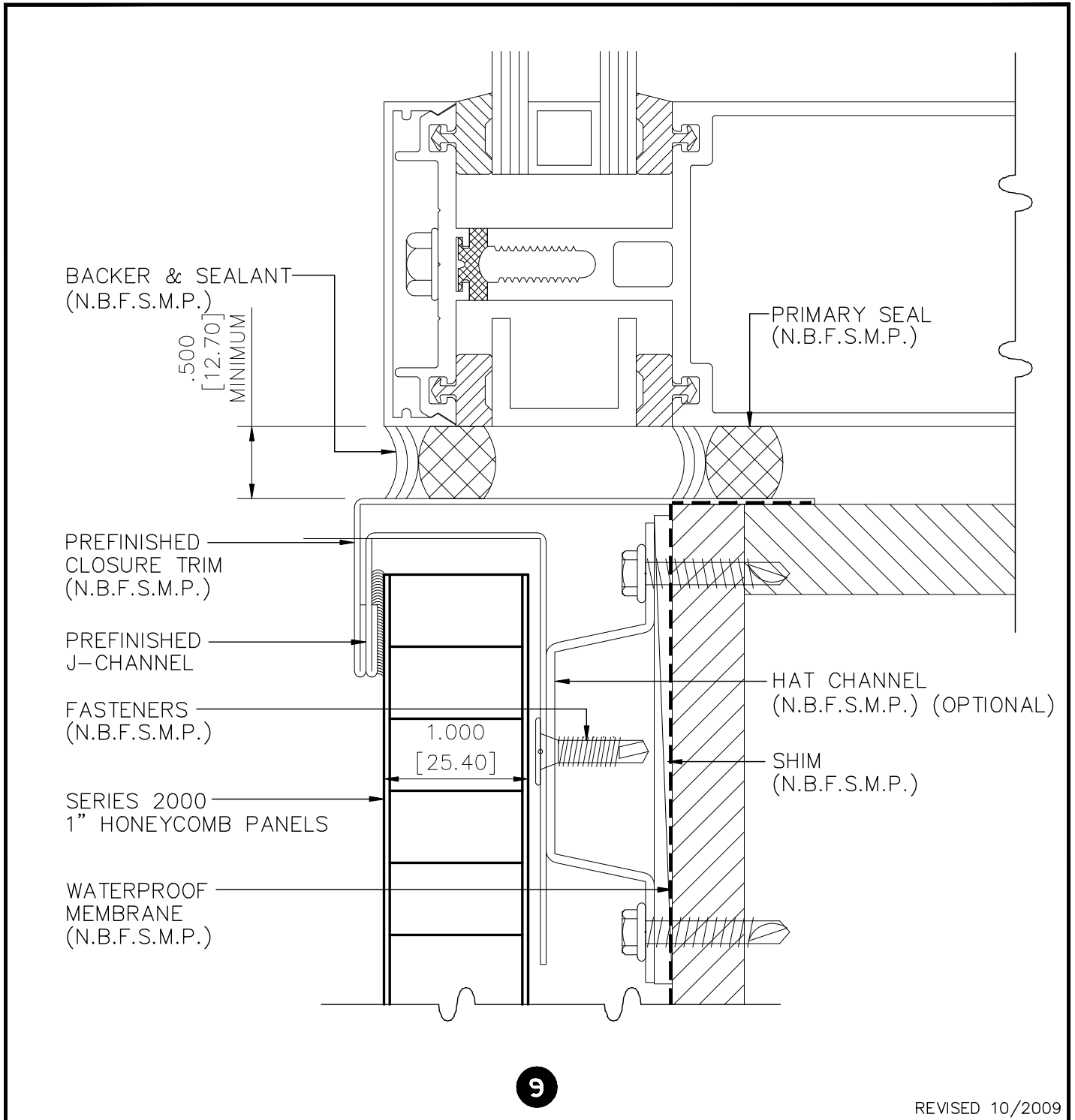

**SERIES 2000 - BASE DETAIL**

**S2000-10**

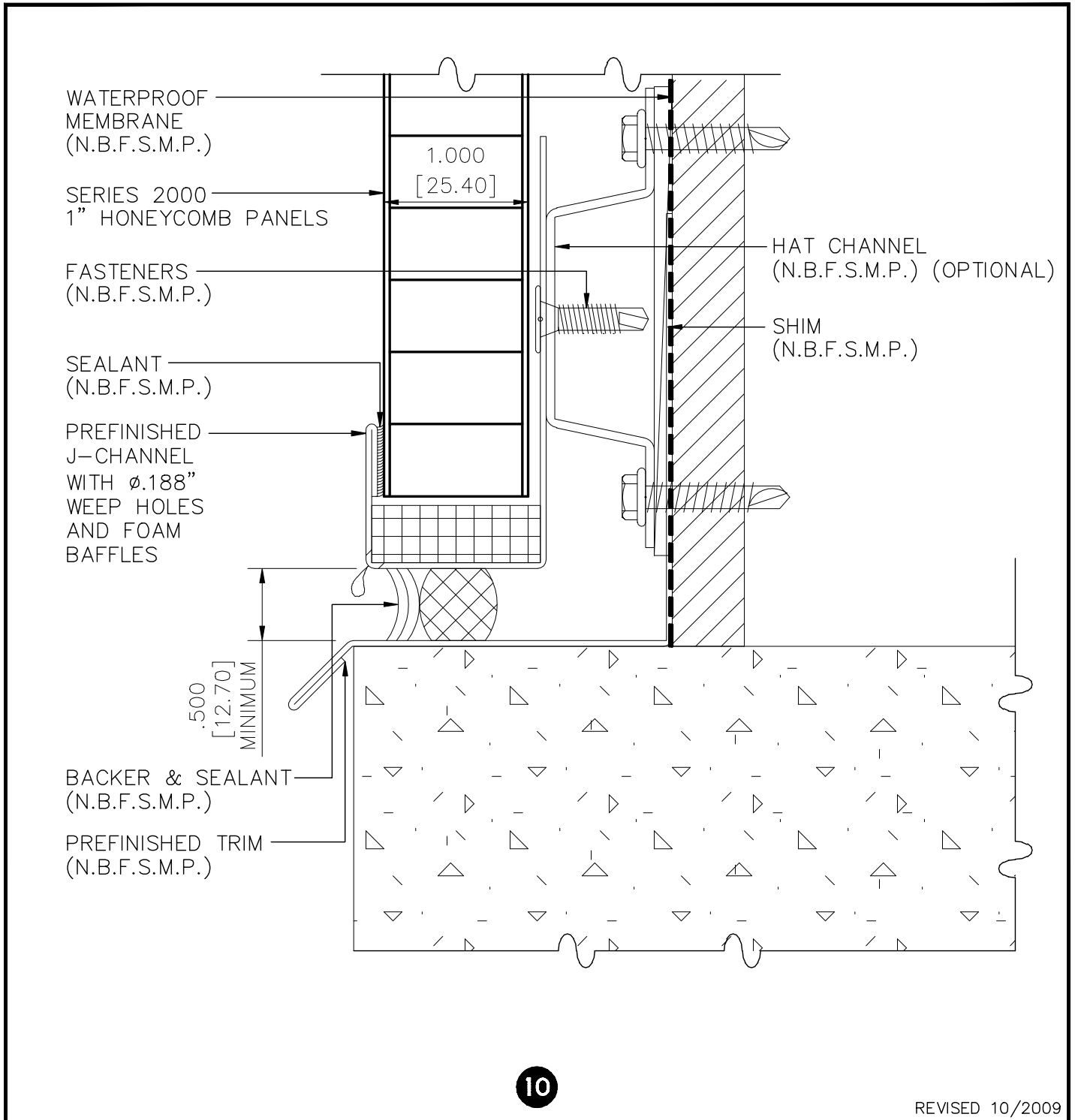

**SERIES 2000 - INSIDE CORNER DETAIL**

**S2000-11**

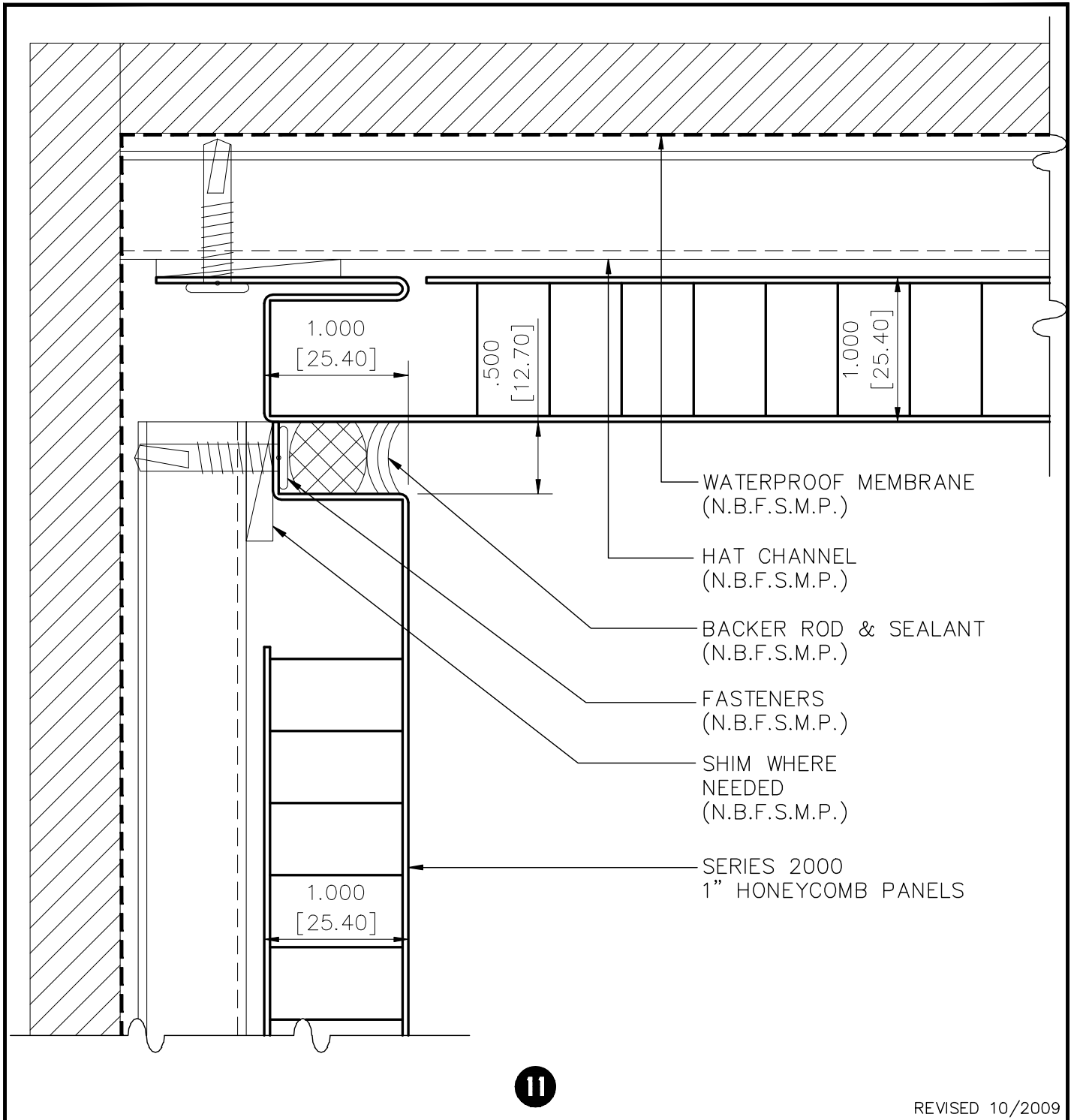



1-800-426-7737

WWW.UNACLAD.COM

## Series 2000 UNA-CLAD Panel

### DESCRIPTION

Aluminum or stainless steel skins laminated to aluminum or kraft paper honeycomb core material. System is mechanically attached with vertical dry-set joint and installed in a sequential pattern.

### FEATURES

- exceptional flatness
- excellent deflection resistance
- very lightweight
- special reveals available
- panels are designed for vertical orientation only
- hairline vertical joint with optional integral factory-applied joint sealant

### MATERIAL OPTIONS

- coil-coated aluminum skins (.040)
- coil-anodized aluminum skins
- post-painted aluminum skins (short run, custom colors)
- stainless steel skins (kraft paper core only)
- panel thickness 1 inch

### FINISH OPTIONS

- Kynar 500®/Hylar 5000® high performance fluorocarbon resinous coatings
- coil anodized
- batch anodized
- stainless steel with #4 brushed-satin and #8 mirror-polished finish
- special coatings

### LIMITATIONS

- panels cannot be radiused
- panel length maximum of 12'-0" (144")
- panel width maximum of 54" (based upon coil availability)