

**SERIES 45 - UNA-CLAD PANEL INDEX**

**S45-00**

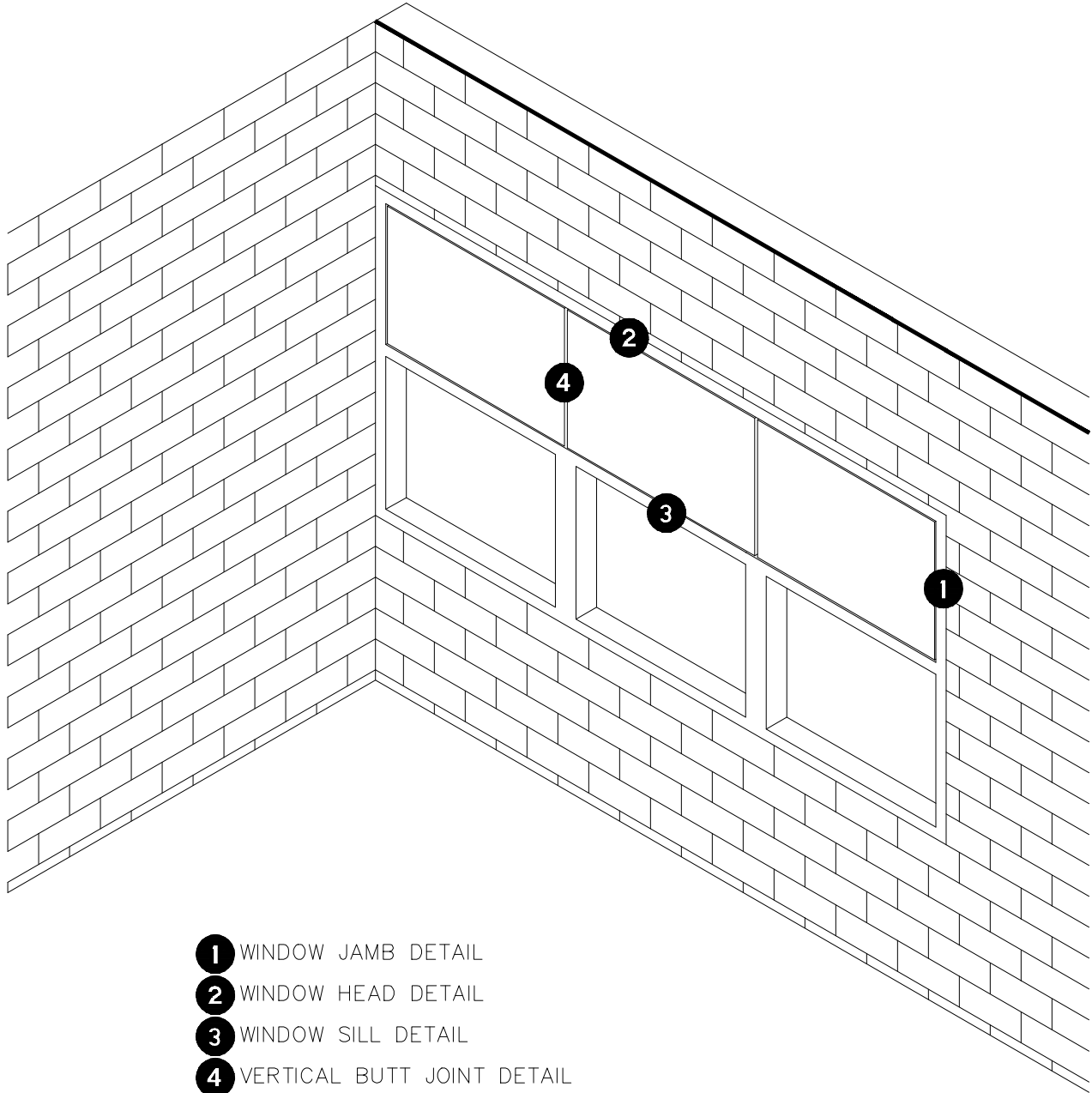

REVISED 10/2009

**SERIES 45 - WINDOW JAMB DETAIL**

**S45-01**

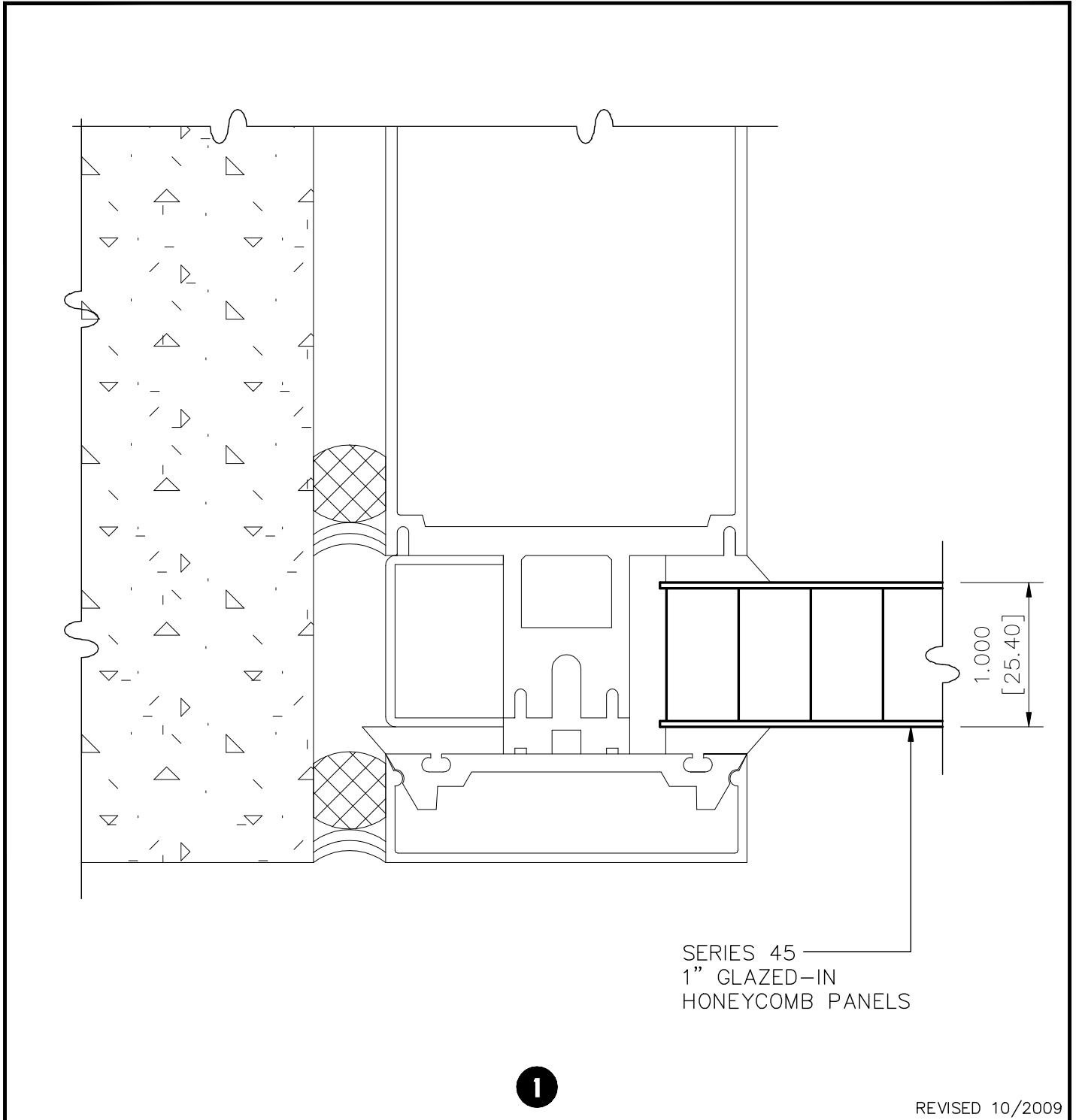

**SERIES 45 - WINDOW HEAD DETAIL**

**S45-02**

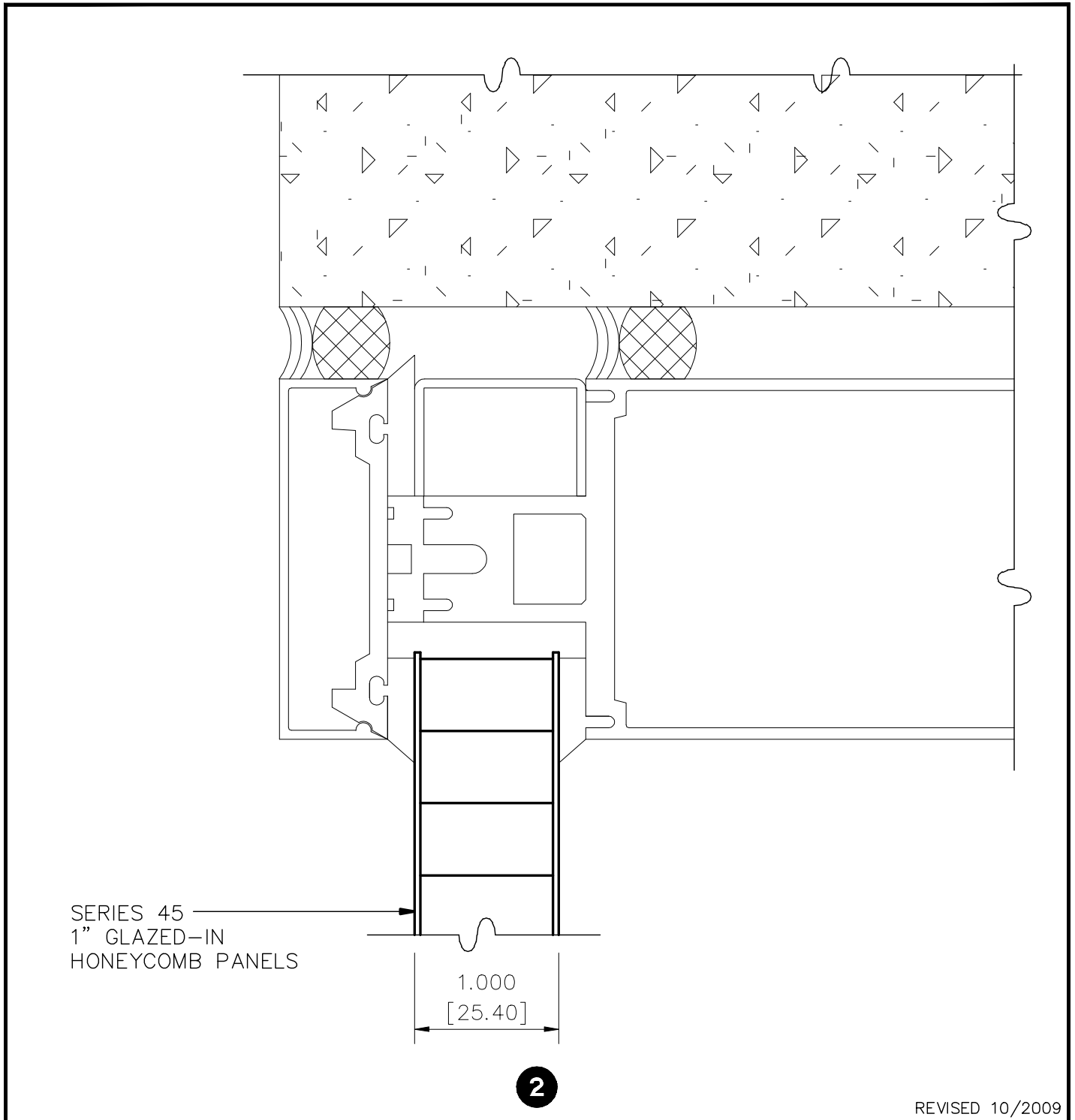

**SERIES 45 - WINDOW SILL DETAIL**

**S45-03**

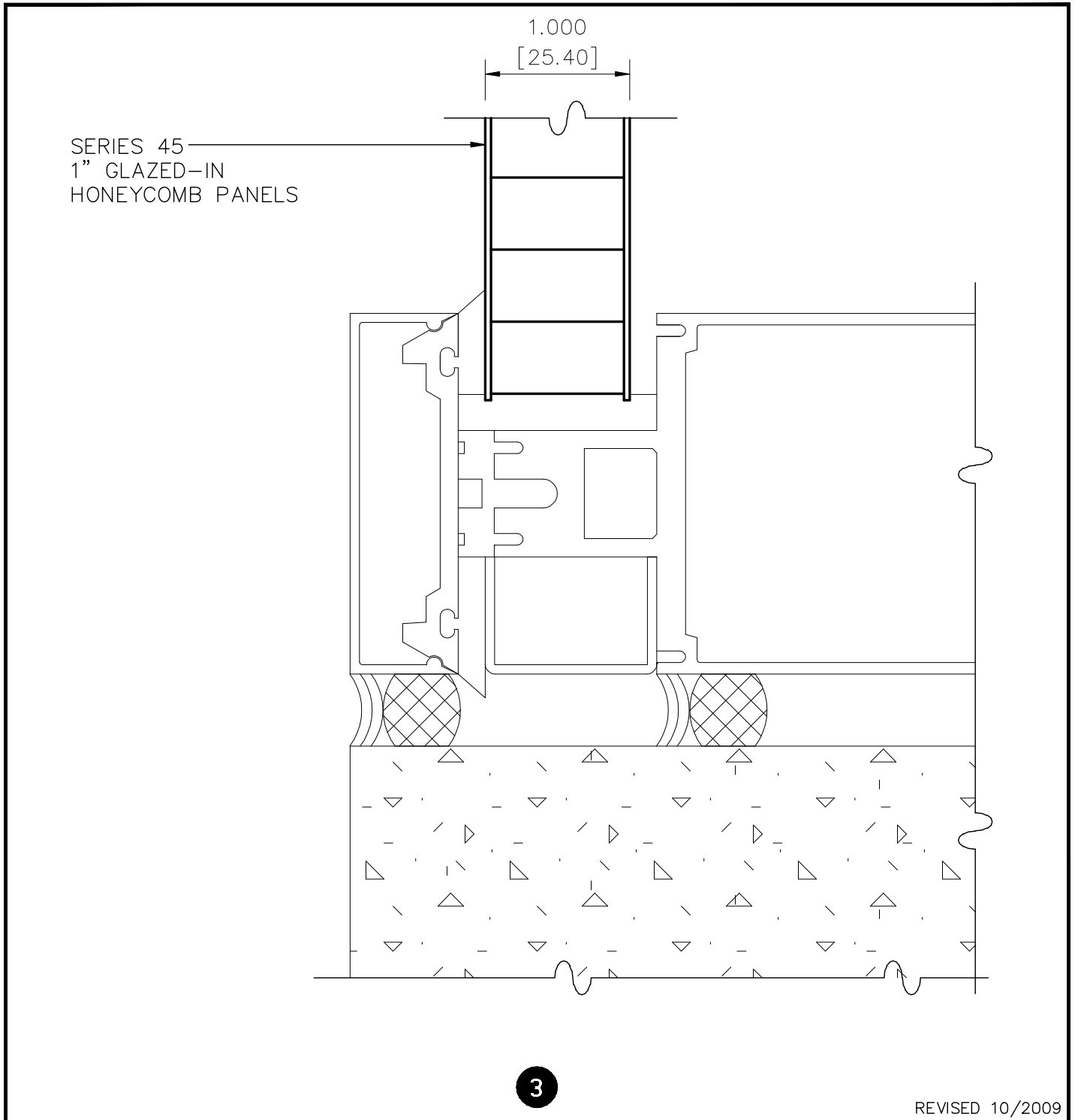

**SERIES 45 - VERTICAL BUTT JOINT DETAIL**

**S45-04**

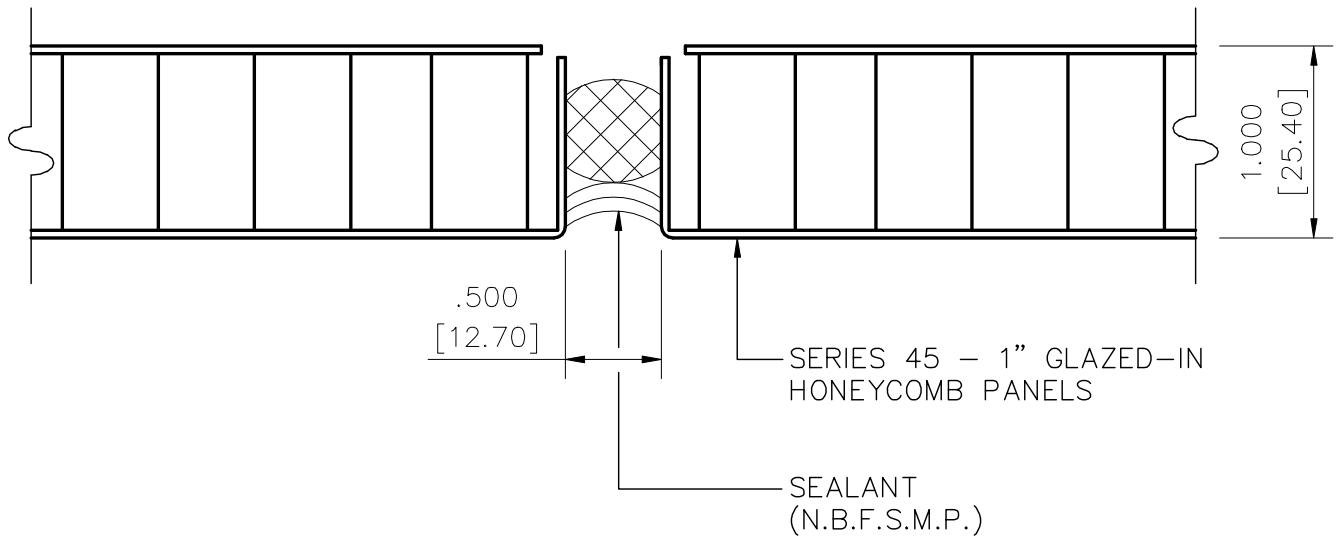



**1-800-426-7737**

**WWW.UNACLAD.COM**

## **Series 30/45**

### UNA-CLAD Panel

#### **DESCRIPTION**

Aluminum or stainless steel skins laminated to aluminum or kraft paper or aluminum honeycomb core material. Systems glaze into window or window wall framing and permit butt-glazing procedures.

#### **FEATURES**

- flatness
- superb deflection resistance
- very lightweight
- glaze-in with thickness adjusted to meet receptor
- butt-glazing capability
- irregular-shaped panels

#### **MATERIAL OPTIONS**

- coil-coated aluminum skins (.040 or .063)
- post-anodized aluminum skins (short run, custom colors)
- stainless steel skins (kraft paper core only)
- panel thickness from 1/4 to 3 inches

#### **FINISH OPTIONS**

- Kynar 500®/Hylar 5000® high performance fluorocarbon resinous coatings
- coil anodized
- batch anodized
- stainless steel with #4 brushed-satin and #8 mirror-polished finish
- fluoropolymer high gloss finish
- special coatings

#### **LIMITATIONS**

- Panels may not be curved
- Panel edges must be straight lines (no curves)
- MAXIMUM NARROW DIMENSION IS 60" (FOR 1-INCH PANEL SERIES 45)