

### UC750 V-GROOVE SOFFIT PANEL INDEX

UC750-00

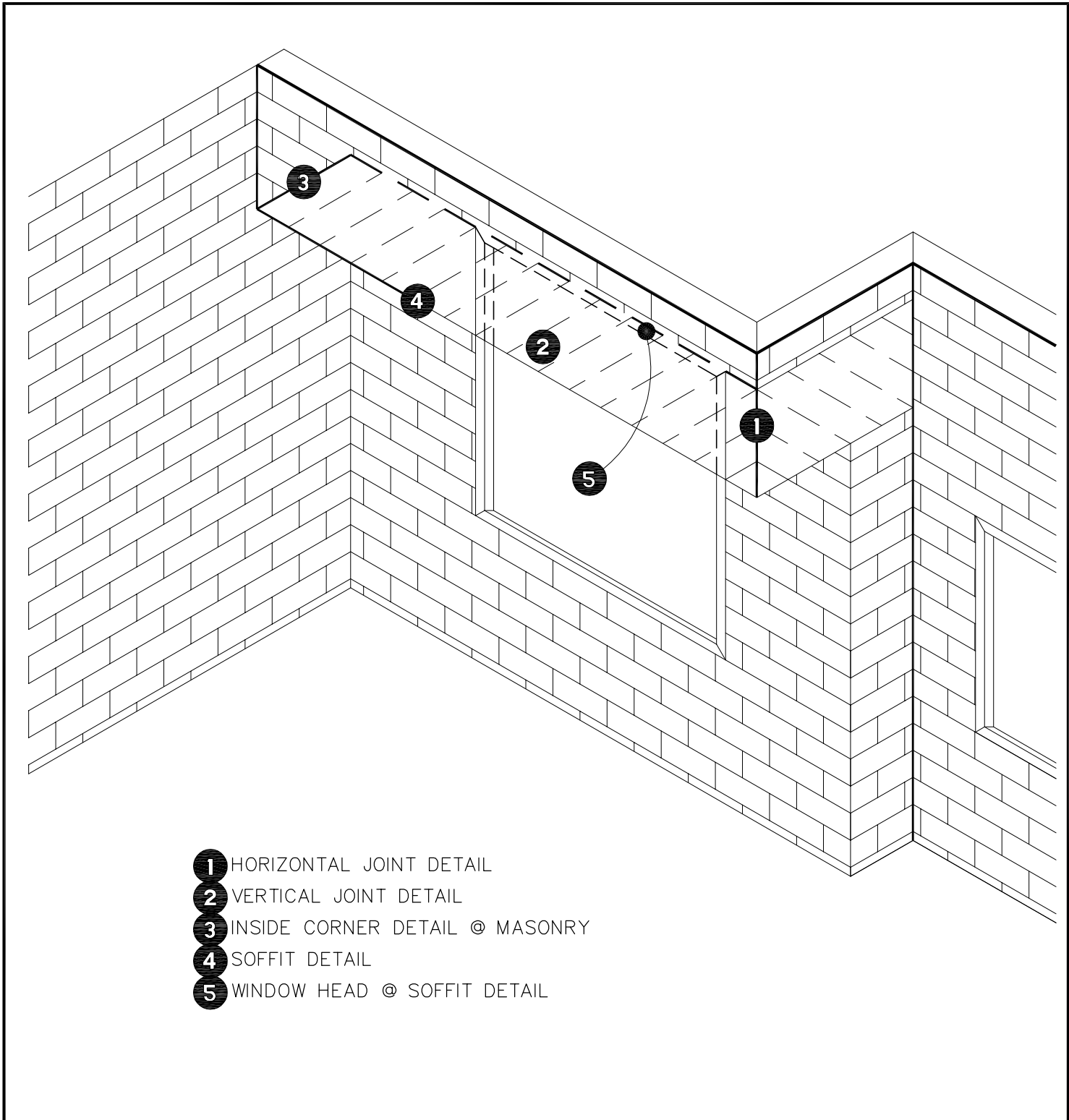

### UC750 HORIZONTAL JOINT DETAIL

UC750-01

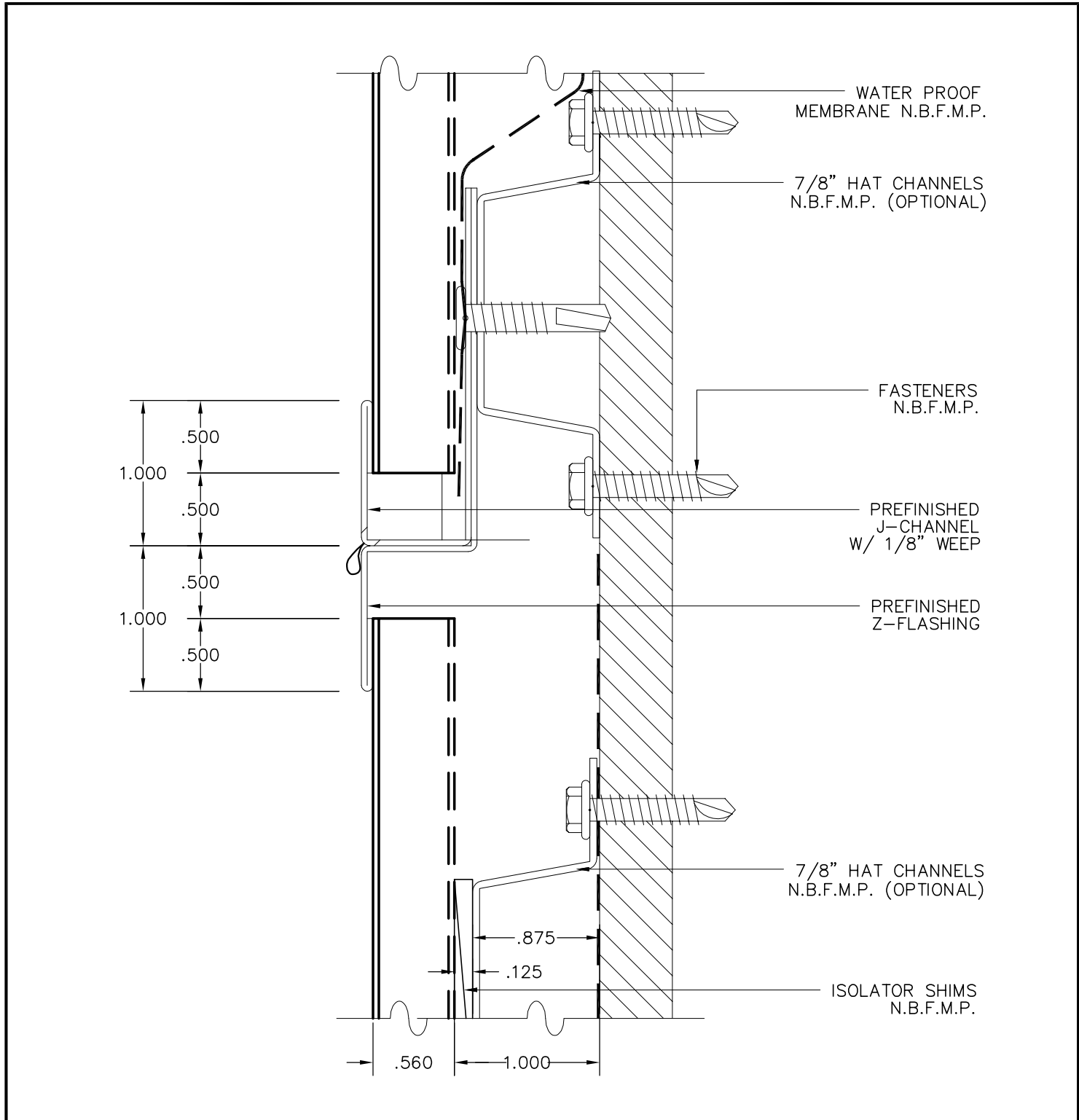

### UC750 VERTICAL JOINT DETAIL

UC750-02

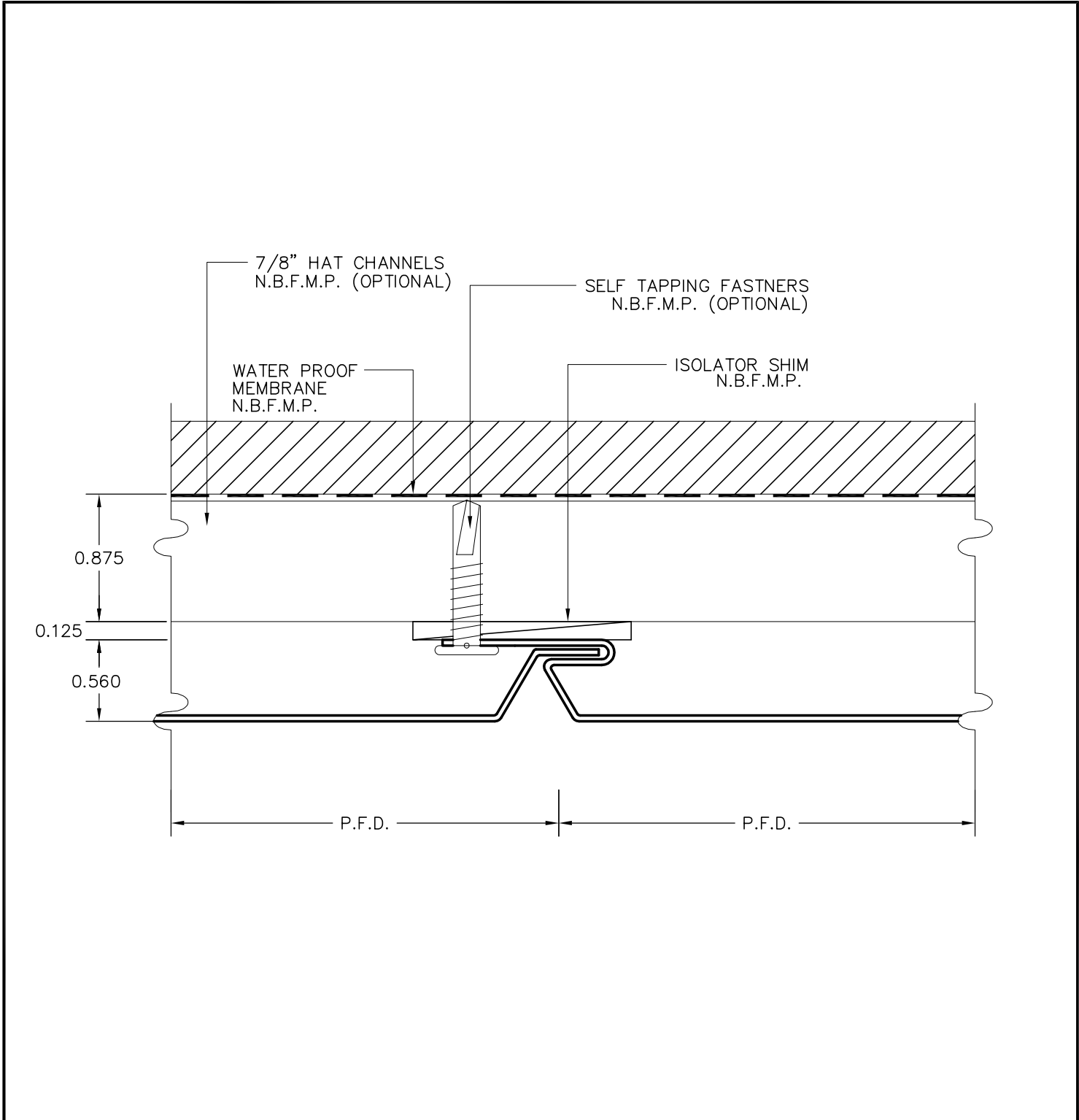

### UC750 INSIDE CORNER DETAIL @ MASONRY

UC750-03

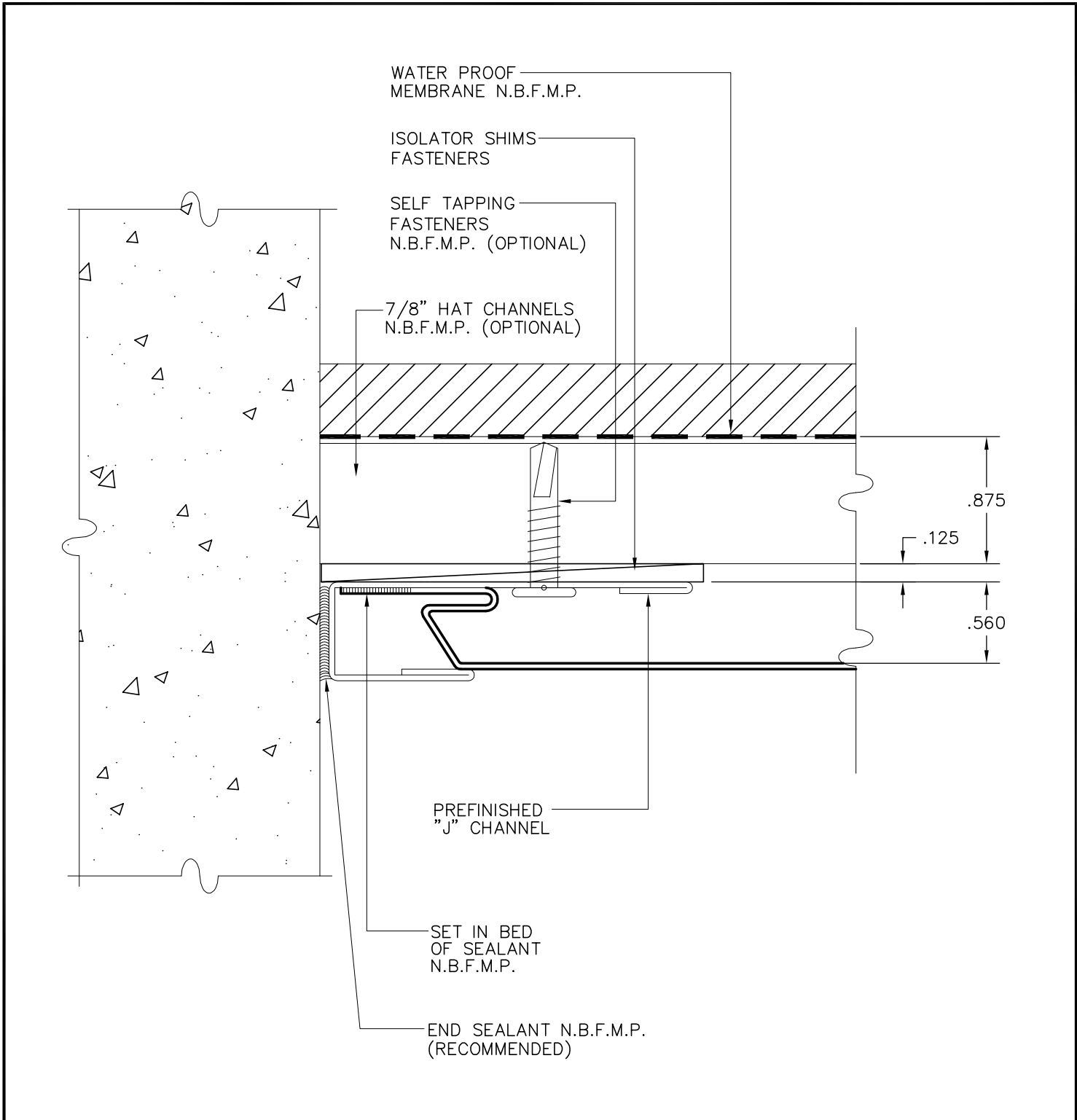

### UC750 SOFFIT DETAIL

UC750-04

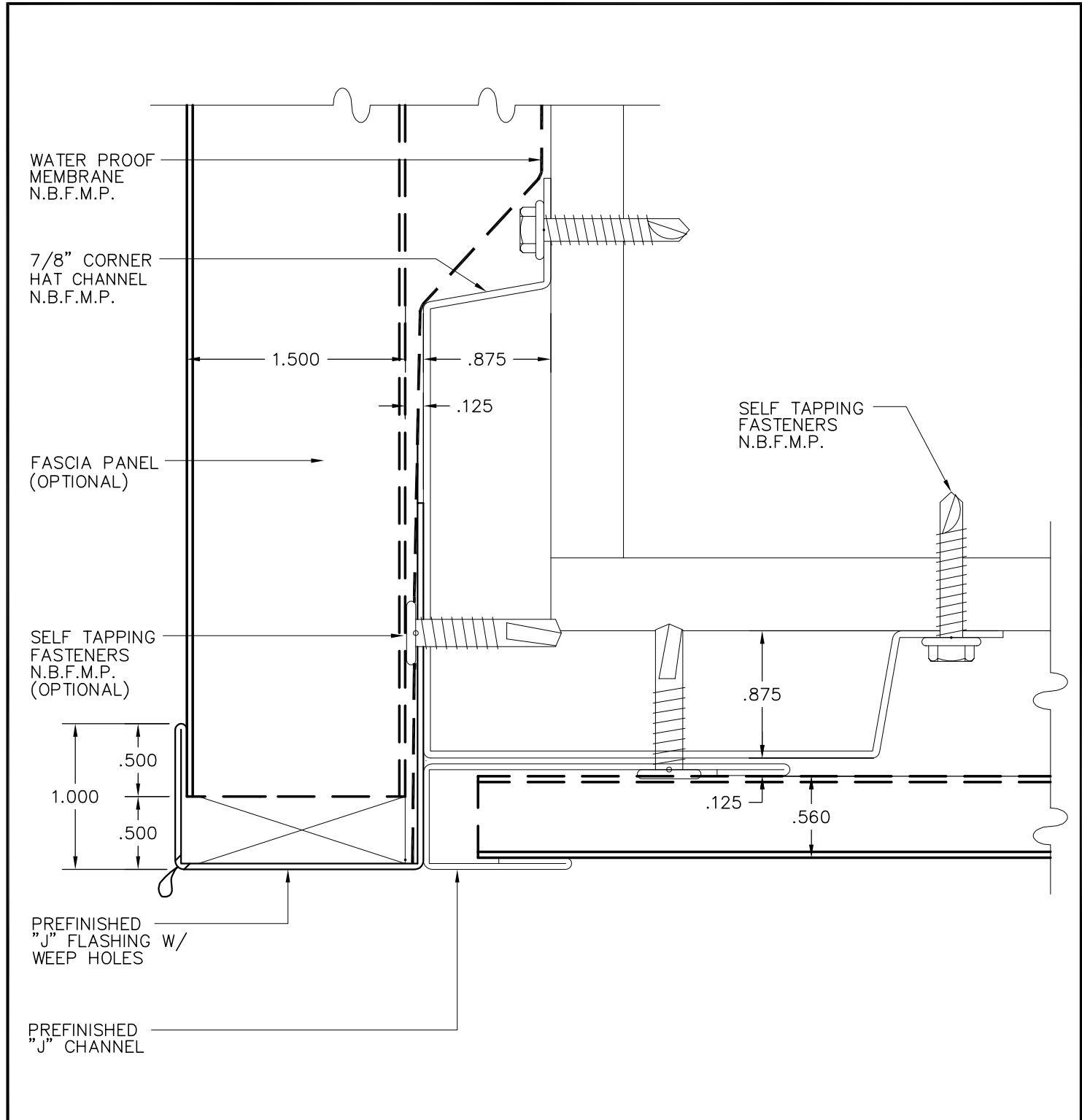

### UC750 WINDOW HEAD DETAIL @ SOFFIT

UC750-05

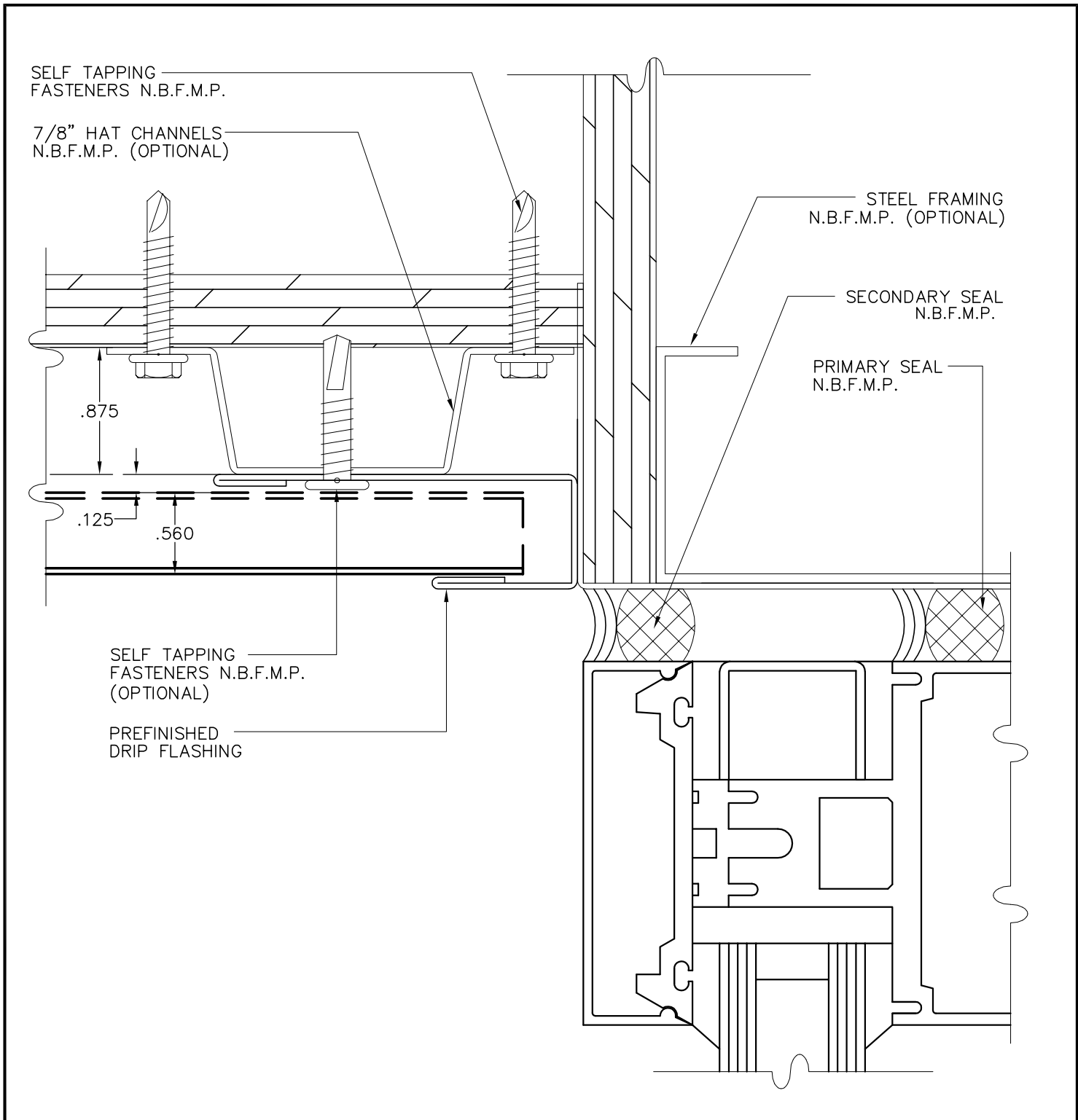

### UC-750 V-GROOVE SOFFIT PANEL

UC750-INFO

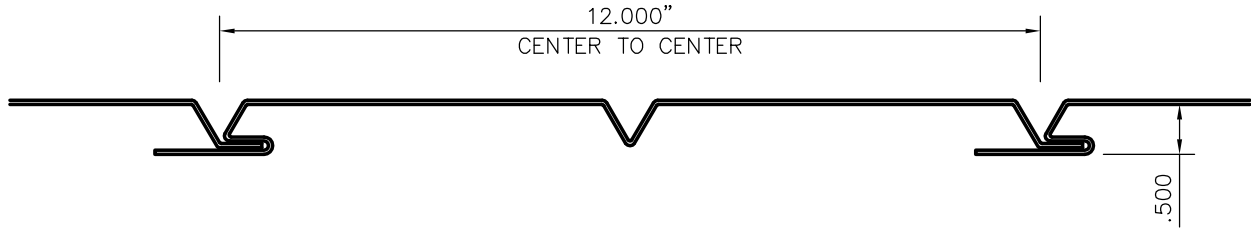

#### MATERIAL OPTIONS

COIL-COATED ALUMINUM  
ANODIZED ALUMINUM  
MILL FINISH ALUMINUM

#### FINISH OPTIONS

**PAINTING**  
HYLAR 5000/KYNAR 500, MODIFIED POLYESTERS, AND OTHER CUSTOM OR EXOTIC FINISHES CAN BE COIL COATED OR SPRAY APPLIED.

**ANODIZING**  
CLEAR, BRONZES, AND VARIOUS OTHER COLORS CAN BE COIL ANODIZED FOR COLOR CONSISTENCY.

**MECHANICAL FINISHES**  
PROVIDES A SURFACE TEXTURE BY MECHANICAL MEANS ALONE. (3) EMBOSSING PATTERNS ARE CURRENTLY AVAILABLE.

**CUSTOM COLORS**  
WE CAN PROVIDE FULL CUSTOM COLOR SERVICES TO MATCH PRACTICALLY ANY MATERIAL, SHADE, OR TINT YOU REQUEST.

#### FABRICATION OPTIONS

ALUMINUM .032"  
MINIMUM LENGTH 24"  
MAXIMUM LENGTH 48'  
BEST O.C. DIMS. 12"  
VENTING AVAILABLE

#### FABRICATION OPTIONS

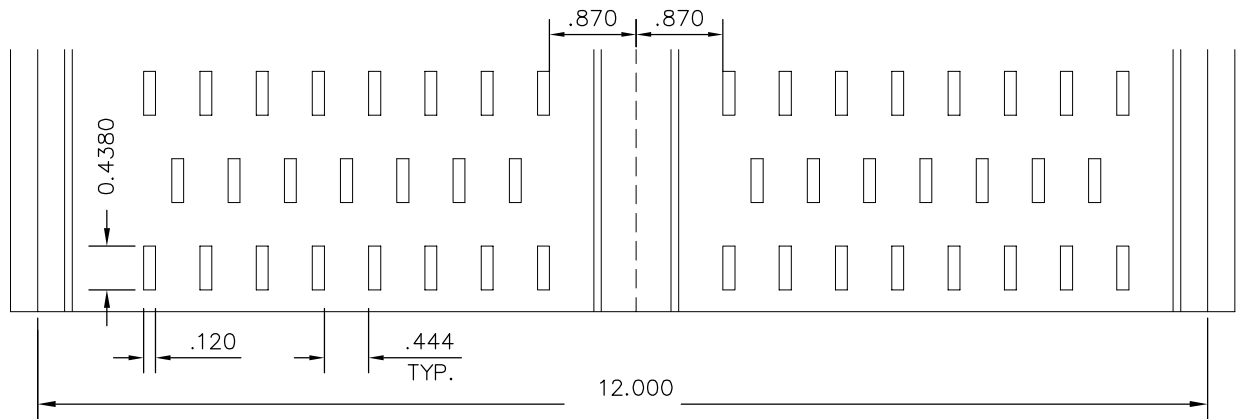

#### NOTES:

1. HEAVIER GAUGES, NARROWER WIDTHS, AND EMBOSSING MINIMIZE "OIL CANNING."
2. OIL CANNING IS NOT A CAUSE FOR REJECTION.
3. AN EXTENSIVE SELECTION OF ASSOCIATED PANEL FLASHINGS AND TRIMS ARE AVAILABLE.
4. CONTACT COPPER SALE, INC. FOR UP-TO-DATE TECHNICAL INFORMATION AND MATERIAL LIMITATIONS.
5. ALL SYSTEMS WITH TESTING MUST BE INSTALLED IN ACCORDANCE WITH THE ASSEMBLY AS TESTED.